



Websters
estate agents

Wordsworth Road, Hampton, TW12 1ER

Mid Terrace 2 bedroom home with a south facing garden and a separate garage just 0.2 miles from bus stops towards Kingston and Heathrow and only 0.3 miles from Hampton Common Parkland.

With no onward chain, in need of complete refurbishment and offering 700 sq ft of well balanced living space over 2 floors.

Entrance hallway leads to storage, the fitted kitchen and the living/dining room at the rear. Sliding doors open onto the south facing garden with a patio, lawn and gated rear access to the vehicular driveway leading to the garage block. On the first floor are 2 double bedrooms and the family bathroom.

Situated 0.4 miles from Buckingham Primary and Hampton High Secondary Schools

EPC Rating E

- Mid Terrace 2 Bedroom Home
- No Onward Chain
- South Facing Garden
- Private Garage in Block
- In Need of Complete Refurbishment
- Popular Residential Location
- 0.2 Miles from Bus Stops



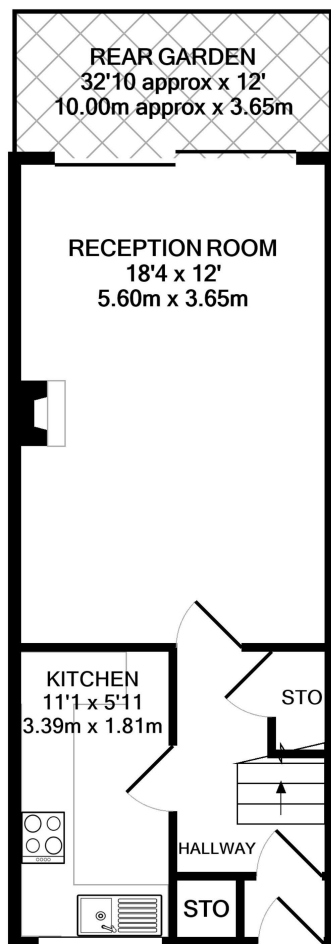

GROUND FLOOR
APPROX. FLOOR
AREA 350 SQ.FT.
(32.5 SQ.M.)

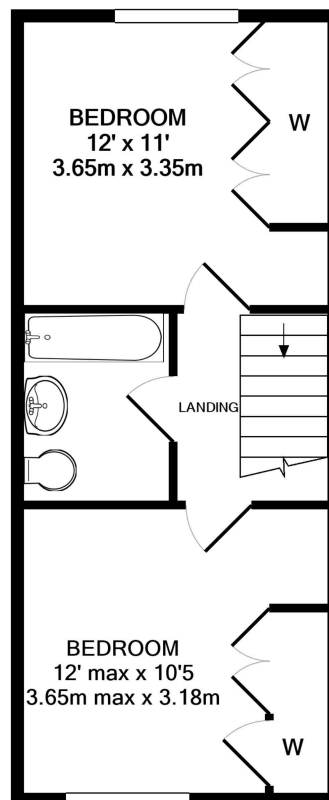

1ST FLOOR
APPROX. FLOOR
AREA 350 SQ.FT.
(32.5 SQ.M.)

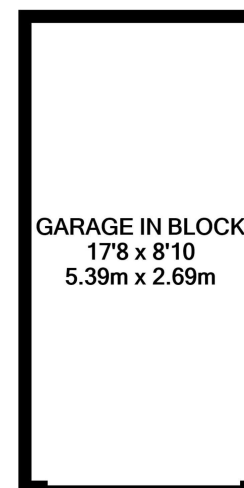

GARAGE IN BLOCK
APPROX. FLOOR
AREA 153 SQ.FT.
(14.2 SQ.M.)

TOTAL APPROX. FLOOR AREA 700 SQ FT (65 SQ M)

a Websters Estate Agents 36 Broad Street, Teddington, Middlesex TW11 8QY

t 020 8614 6000

e sales@mywebsters.co.uk **w** mywebsters.co.uk

Disclaimer

These particulars, whilst believed to be accurate are set out as a general outline only for guidance and do not constitute any part of an offer or contract. Intending purchasers should not rely on them as statements of representation of fact, but must satisfy themselves by inspection or otherwise as to their accuracy. We have not carried out a detailed survey nor tested the services, appliances and specific fittings. Room sizes should not be relied upon for carpets and furnishings. The measurements given are approximate. No person in this firm's employment has the authority to make or give any representation or warranty in respect of the property.

