



Websters
estate agents

Portugal Gardens, Twickenham, TW2 5HE

Semi Detached 4 bedroom family home in a popular residential location with a southerly aspect garden, home office and garage with rear vehicular access. Situated 0.5 miles from Trafalgar Primary and Waldegrave Girls/Co-ed Sxth Form and within 0.9 miles of St James, Stanley and Archdeacon Primary Schools.

Extended at the rear, loft converted and refurbished to offer 1367 sq ft of well proportioned living space over 3 floors with high specification fixtures, fittings and floorings, double glazed windows and doors and modern decor throughout.

Entrance hallway leads to the bay fronted living room and the kitchen with stylish fitted units and access to the open plan dining/family room at the rear. This light filled room has wood flooring, built in storage, a roof light and space for dining and seating. Double doors open onto the rear garden with a patio, lawn, home office, brick built garage/store room and secure gated side access. On the first floor are 2 double bedrooms, the study, the shower room and stairs up to 2 further bedrooms and the family bathroom.

Located 0.2 miles from Crane Park, 0.3 miles from local shops and 0.5 miles from the A316 with direct access to the M3/M25 and into central London.
EPC Rating D

- Semi Detached 4 Bedroom Home
- Extended, Loft Converted and Refurbished
- Southerly Aspect Garden
- Garden Home Office and Large Garage
- 1367 Sq Ft of Living Space over 3 Floors
- 0.2 Miles from Crane Park
- Close to Numerous Popular Schools



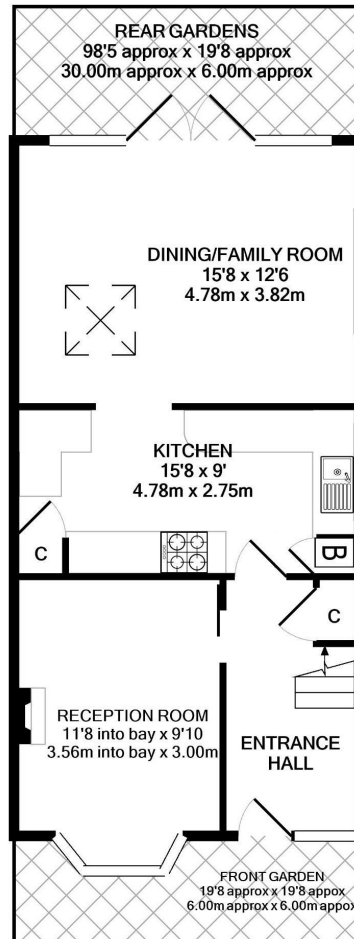

GROUND FLOOR
APPROX. FLOOR
AREA 541 SQ.FT.
(50.2 SQ.M.)

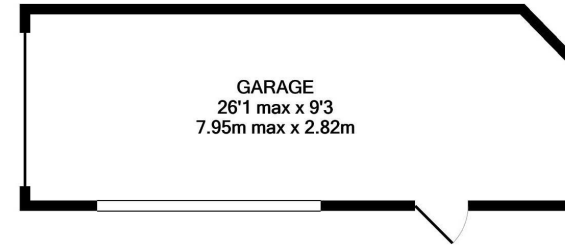
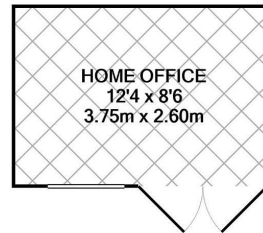

BEDROOM

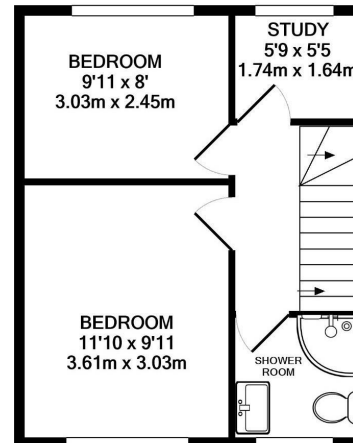

1ST FLOOR
APPROX. FLOOR
AREA 568 SQ.FT.
(52.8 SQ.M.)

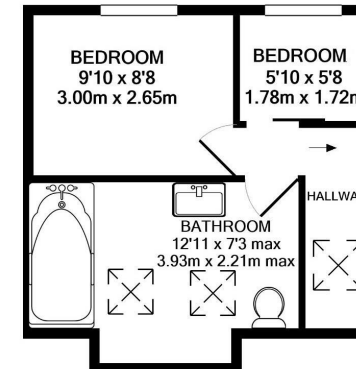

2ND FLOOR
APPROX. FLOOR
AREA 258 SQ.FT.
(24.0 SQ.M.)

TOTAL APPROX. FLOOR AREA 1367 SQ.FT. (127.0 SQ.M.)

[a](#) Websters Estate Agents 36 Broad Street, Teddington, Middlesex TW11 8QY

[t](#) 020 8614 6000

[e](#) sales@mywebsters.co.uk [w mywebsters.co.uk](http://mywebsters.co.uk)

Disclaimer

These particulars, whilst believed to be accurate are set out as a general outline only for guidance and do not constitute any part of an offer or contract. Intending purchasers should not rely on them as statements of representation of fact, but must satisfy themselves by inspection or otherwise as to their accuracy. We have not carried out a detailed survey nor tested the services, appliances and specific fittings. Room sizes should not be relied upon for carpets and furnishings. The measurements given are approximate. No person in this firm's employment has the authority to make or give any representation or warranty in respect of the property.

