



Websters
estate agents

Marsh Farm Road, Twickenham, TW2 6SH

Mid Terrace 2 double bedroom Victorian family home with a private west facing garden. Situated in a popular residential location just 0.3 miles from Twickenham Green, local shops, cafes and restaurants and 0.5 miles from Twickenham town centre and mainline train station

Tastefully presented to offer 605 Sq ft of living space over 2 floors with modern fixtures, fittings and floorings, charming period features, double glazed sash style windows and neutral decor throughout.

Front door opens into the living room with access to the dining room with a stylish integrated kitchen and space for dining. A lobby area leads to the family bathroom and the low maintenance courtyard garden at the rear. On the first floor are 2 double bedrooms and hatch access to loft storage.

Located 0.4 miles from Archdeacon and St Richard Reynolds School and less than 0.7 miles from Trafalgar Primary, Strawberry Hill train station and Kneller Gardens with a bike and walking track along the River Crane to Crane Park.
EPC Rating C

- Mid Terrace Victorian Cottage
- 2 Double Bedrooms
- West Facing Garden
- Living Room and Kitchen/Diner
- Tastefully Presented Throughout
- 0.5 Miles from Twickenham Station
- 0.3 Miles from Twickenham Green





GROUND FLOOR
APPROX. FLOOR
AREA 31.7 SQ.M.
(341 SQ.FT.)

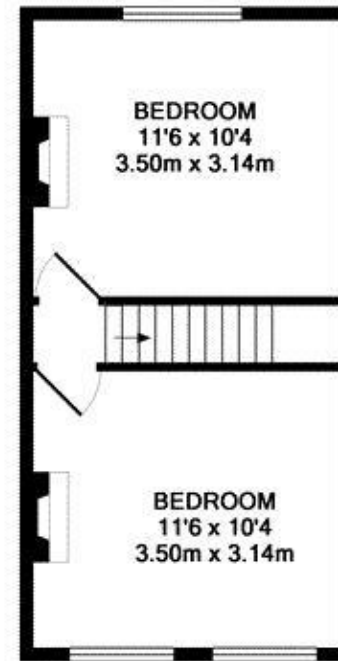

1ST FLOOR
APPROX. FLOOR
AREA 24.5 SQ.M.
(264 SQ.FT.)

TOTAL APPROX. FLOOR AREA 56.2 SQ.M. (605 SQ.FT.)

[a](#) Websters Estate Agents 164 Heath Road, Twickenham, Middlesex TW1 4BN

[t](#) 020 8892 3343

[e](#) sales@mywebsters.co.uk [w](#) mywebsters.co.uk

Disclaimer

These particulars, whilst believed to be accurate are set out as a general outline only for guidance and do not constitute any part of an offer or contract. Intending purchasers should not rely on them as statements of representation of fact, but must satisfy themselves by inspection or otherwise as to their accuracy. We have not carried out a detailed survey nor tested the services, appliances and specific fittings. Room sizes should not be relied upon for carpets and furnishings. The measurements given are approximate. No person in this firm's employment has the authority to make or give any representation or warranty in respect of the property.

