



Websters
estate agents

Marsh Farm Road, Twickenham, TW2 6SH

Mid Terrace 3 bedroom Victorian family home with a west facing garden and purpose built home office in a popular residential location just 0.3 miles from Twickenham Green, local shops, cafes and restaurants and 0.5 miles from Twickenham town centre and mainline train station

Extended at the rear and immaculately presented to offer 929 sq ft of contemporary style living space over 3 floors with high specification fixtures, fittings and floorings, large double glazed windows and doors, a vaulted hallway ceiling, a loft mezzanine bedroom/playroom and neutral decor throughout.

Front door leads into the open plan living area with wood floors, an exposed brick chimney, built in storage, space for seating, a dining area and the fitted kitchen. At the rear is the family bathroom and a door onto the low maintenance garden with a deck, stone paving, planting and the stylish, fully equipped home office. On the first floor is the shower room and 3 bedrooms, the middle with a fixed wooden ladder up to the mezzanine sleeping area.

Located 0.4 miles from Archdeacon and St Richard Reynolds School and less than 0.7 miles from Trafalgar Primary, Strawberry Hill train station and Kneller Gardens with a bike and walking track along the River Crane to Crane Park.
EPC Rating D

- Mid Terrace Victorian Family Home
- 3 Bedrooms and Mezzanine Loft Room
- Architect Designed Extension and Home Office
- 929 Sq Ft of Living Space Over 3 Floors
- Low Maintenance West Facing Garden
- Immaculately Presented Throughout
- Within 0.7 Miles of Popular Schools
- 0.5 Miles from Twickenham Train Station



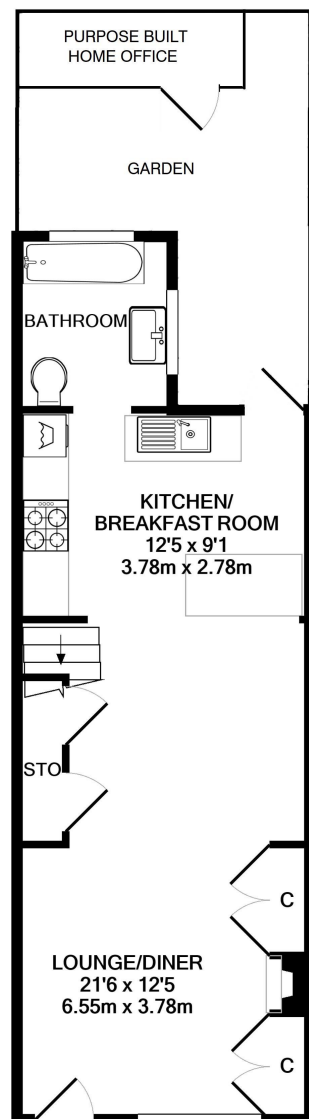

GROUND FLOOR
APPROX. FLOOR
AREA 437 SQ.FT.
(40.6 SQ.M.)

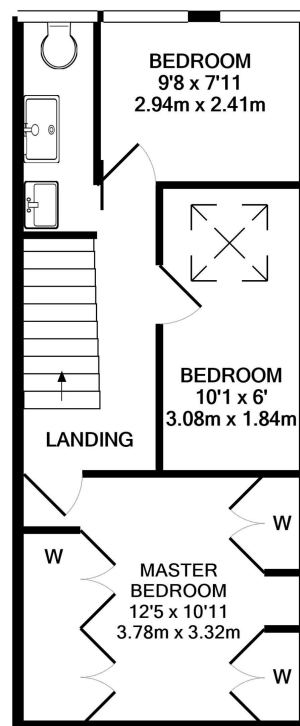

1ST FLOOR
APPROX. FLOOR
AREA 379 SQ.FT.
(35.2 SQ.M.)

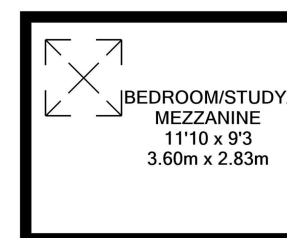

2ND FLOOR
APPROX. FLOOR
AREA 113 SQ.FT.
(10.5 SQ.M.)

TOTAL APPROX. FLOOR AREA 929 SQ.FT. (86.3 SQ.M.)

[a](#) Websters Estate Agents 36 Broad Street, Teddington, Middlesex TW11 8QY

[t](#) 020 8614 6000

[e](#) sales@mywebsters.co.uk [w](#) mywebsters.co.uk

Disclaimer

These particulars, whilst believed to be accurate are set out as a general outline only for guidance and do not constitute any part of an offer or contract. Intending purchasers should not rely on them as statements of representation of fact, but must satisfy themselves by inspection or otherwise as to their accuracy. We have not carried out a detailed survey nor tested the services, appliances and specific fittings. Room sizes should not be relied upon for carpets and furnishings. The measurements given are approximate. No person in this firm's employment has the authority to make or give any representation or warranty in respect of the property.

