



100  
H  
4 2

100

Websters  
estate agents



# Norcutt Road, Twickenham, TW2 6SR

Mid Terrace 3 bedroom Victorian family home with a west facing garden in a popular residential area just 0.2 miles from Twickenham Green, local shops and restaurants and only 0.7 miles from Strawberry Hill and Twickenham mainline train stations.

Extended and completely refurbished to offer 888 sq ft of well balanced living space over 3 floors with high specification fixtures, fittings and floorings, double glazed sash windows with plantation style shutters, energy efficient boiler, lighting and appliances and stylish modern decor throughout.

Front door opens into the living room with wood flooring, a feature brick chimney with wood burning stove and open access into the kitchen area with a tiled floor, stylish fitted units and space for a dining table and chairs. Double doors open onto low maintenance, west facing garden.

On the first floor are 2 bedrooms, the luxury family bathroom and a door leading upstairs to the main bedroom with built in and eaves storage.

Located 0.3 miles from Archdeacon Primary, 0.6 miles from Trafalgar Primary, St Richard Reynolds School and Twickenham town centre and 0.7 miles from Church Street and Twickenham Riverside with a towpath walk along the Thames past Marble Hill Park to Richmond.

EPC Rating D

- Mid Terrace Victorian Family Home
- 3 Bedrooms and Luxury Bathroom
- West Facing Garden
- Open Plan Family Living Space
- High Specification Throughout
- Within 0.6 Miles of Popular Schools
- 0.2 Miles from Twickenham Green



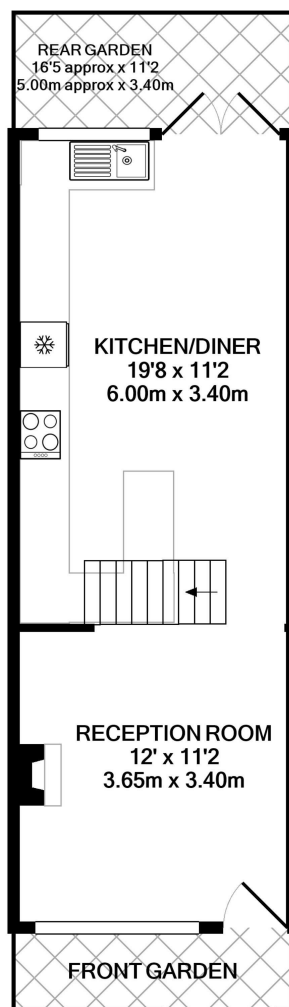

GROUND FLOOR  
APPROX. FLOOR  
AREA 353 SQ.FT.  
(32.7 SQ.M.)

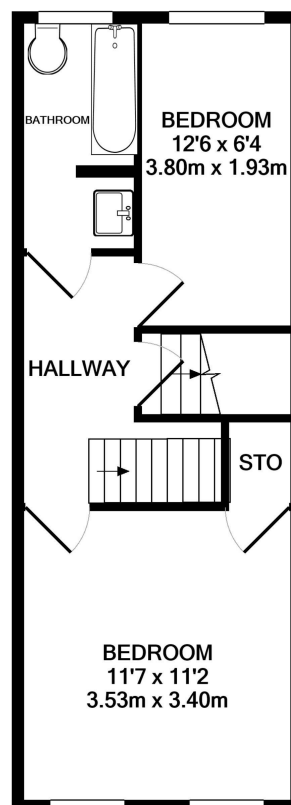

1ST FLOOR  
APPROX. FLOOR  
AREA 350 SQ.FT.  
(32.5 SQ.M.)

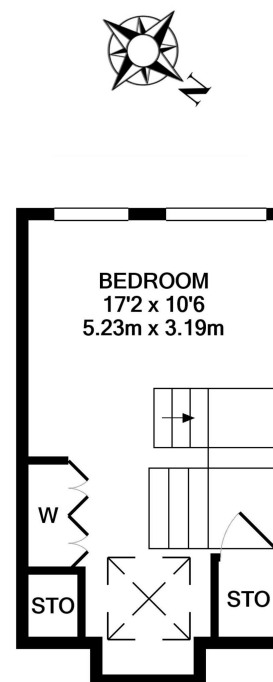

2ND FLOOR  
APPROX. FLOOR  
AREA 185 SQ.FT.  
(17.2 SQ.M.)

TOTAL APPROX. FLOOR AREA 888 SQ.FT. (82.5 SQ.M.)

**a** Websters Estate Agents 36 Broad Street, Teddington, Middlesex TW11 8QY

**t** 020 8614 6000

**e** sales@mywebsters.co.uk **w** mywebsters.co.uk

**Disclaimer**

These particulars, whilst believed to be accurate are set out as a general outline only for guidance and do not constitute any part of an offer or contract. Intending purchasers should not rely on them as statements of representation of fact, but must satisfy themselves by inspection or otherwise as to their accuracy. We have not carried out a detailed survey nor tested the services, appliances and specific fittings. Room sizes should not be relied upon for carpets and furnishings. The measurements given are approximate. No person in this firm's employment has the authority to make or give any representation or warranty in respect of the property.



