



Websters  
estate agents

# Campbell Close, Twickenham, TW2 5BZ

Mid Terrace 3 bedroom family home in a quiet and popular family friendly cul-de-sac backing onto private open fields and the River Crane. Situated just 0.2 miles from Trafalgar Infant/Primary and less than 0.5 miles from Waldegrave Girls/Co-ed Sixth Form, Archdeacon Primary and Kneller Gardens with access to a bike/walking track along the River Crane towards Twickenham Station and Crane Park.

Tastefully presented to offer 761 sq ft of well balanced living space over 2 floors with modern fixtures and fittings, large double glazed windows and doors and neutral decor throughout.

Entrance hallway leads to the dual aspect, open plan living/dining room with wood flooring, a feature fireplace and access to the separate fitted kitchen. Doors in the kitchen and living room open onto the lovely paved garden with mature planting and shed storage. On the first floor are 3 bedrooms, the family bathroom and hatch access to loft storage.

Located just 0.4 miles from Twickenham Green, local shops and restaurants and within 1 mile of Twickenham, Whitton and Strawberry Hill Train Stations.  
EPC Rating D

- Mid Terrace 3 Bedroom Home
- Popular Cul-de-Sac Location
- Front and Rear Garden
- Open Plan Living/Dining Room
- Tastefully Presented Throughout
- Within 0.5 Miles of Schools
- 0.4 Miles from Twickenham Green



## Campbell Close

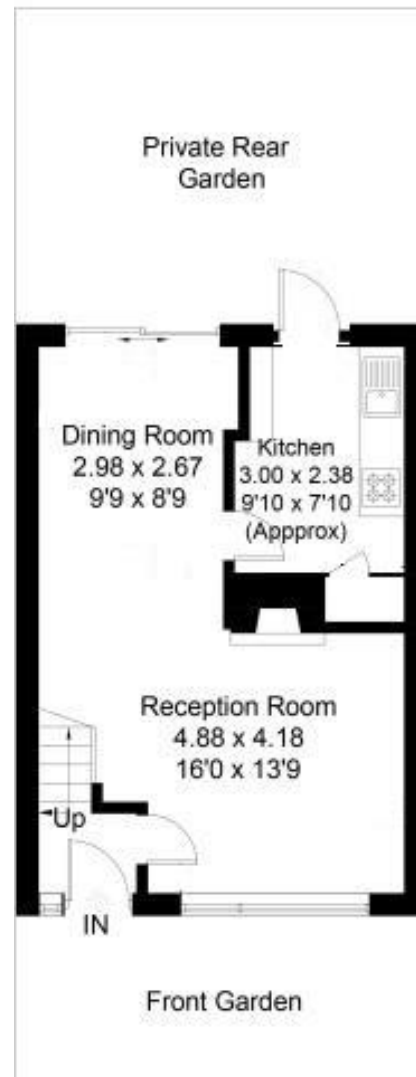

**Ground Floor**



**First Floor**

Approximate Gross Internal Area = 70.7 sq m / 761 sq ft

[a](#) Websters Estate Agents 36 Broad Street, Teddington, Middlesex TW11 8QY

[t](#) 020 8614 6000

[e](#) [sales@mywebsters.co.uk](mailto:sales@mywebsters.co.uk) [w](#) [mywebsters.co.uk](http://mywebsters.co.uk)

**Disclaimer**

These particulars, whilst believed to be accurate are set out as a general outline only for guidance and do not constitute any part of an offer or contract. Intending purchasers should not rely on them as statements of representation of fact, but must satisfy themselves by inspection or otherwise as to their accuracy. We have not carried out a detailed survey nor tested the services, appliances and specific fittings. Room sizes should not be relied upon for carpets and furnishings. The measurements given are approximate. No person in this firm's employment has the authority to make or give any representation or warranty in respect of the property.

