



Websters
estate agents

Radnor Gardens, Strawberry Hill, TW1 4NA

End of Terrace 3 double bedroom Victorian home with a south facing garden. Situated in a desirable Strawberry Hill residential area just 0.4 miles from Twickenham Green, within 0.5 miles of Archdeacon Primary and St Richard Reynolds and 0.8 miles from Trafalgar and St James Primary Schools.

Extended and loft converted to offer 1185 sq ft of well proportioned living space over 3 floors with modern fixtures, fittings and floorings, sash windows, period features, underfloor heating in the kitchen/dining area, neutral decor and planning permission in place to extend/reconfigure the layout on ground floor (application 19/1894/HOT at www.richmond.gov.uk)

Entrance hallway leads to the open plan bay fronted living room with plantation style shutters, a wood burning stove and access to the kitchen/breakfast room. This light filled room has a tiled floor, feature brick wall, fitted kitchen, space for dining and a vaulted glass roof. Doors open onto the garden with a patio, lawn, planting, shed storage and gated side access. On the first floor are 2 double bedrooms and the family bathroom. Stairs lead up to the shower room and the master bedroom both with extensive eaves storage.

Located 0.2 miles from Twickenham town centre, 0.5 miles from Strawberry Hill station and only 0.7 miles from Twickenham mainline station.
EPC Rating D

- End of Terrace Victorian Home
- 3 Double Bedrooms and 2 Bathrooms
- South Facing Garden
- Planning Permission to Extend
- Tastefully Presented Throughout
- 0.7 Miles from Twickenham Station
- Close to Popular Schools



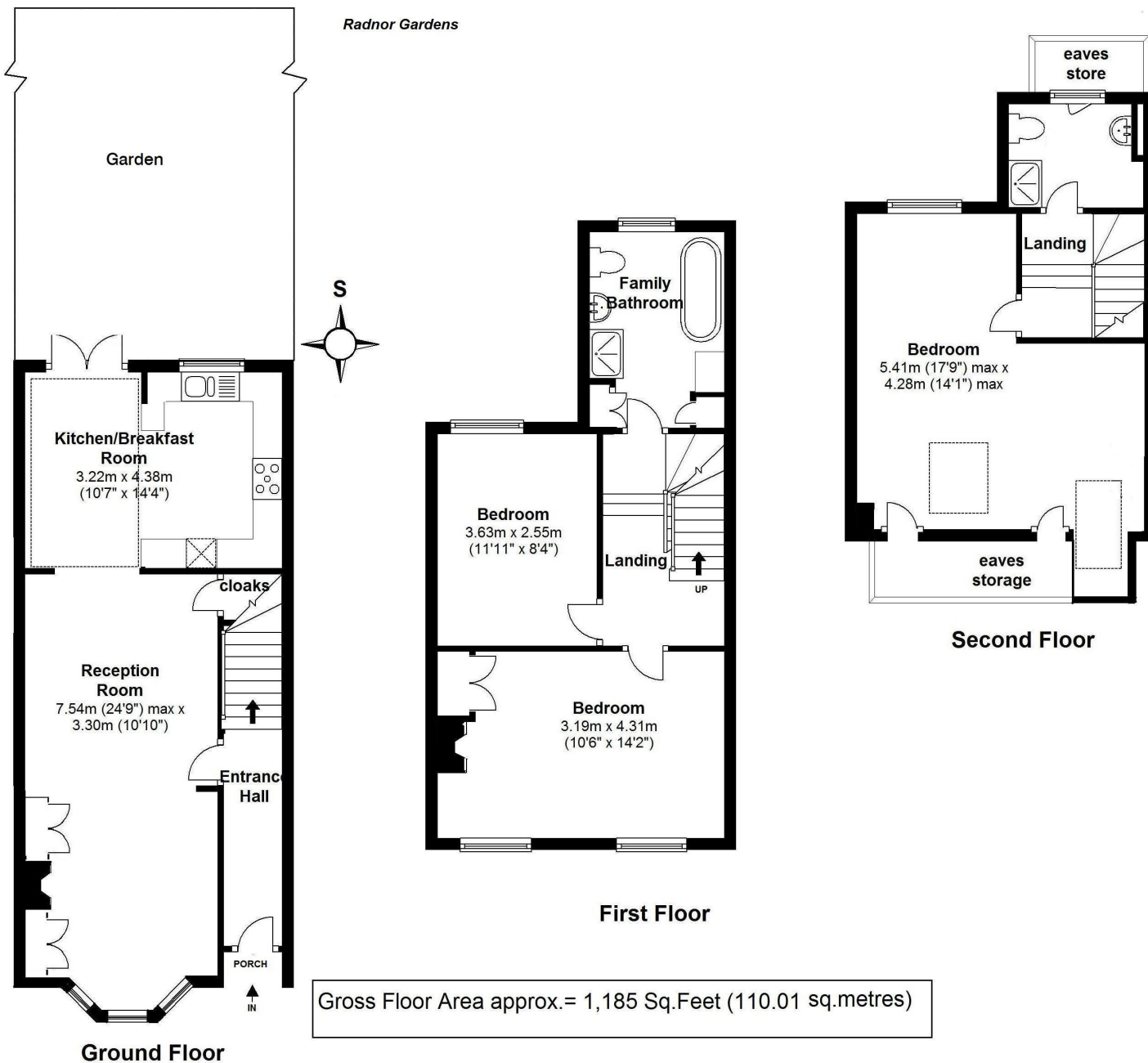

a Websters Estate Agents 164 Heath Road, Twickenham, Middlesex TW1 4BN

t 020 8892 3343

e sales@mywebsters.co.uk **w** mywebsters.co.uk

Disclaimer

These particulars, whilst believed to be accurate are set out as a general outline only for guidance and do not constitute any part of an offer or contract. Intending purchasers should not rely on them as statements of representation of fact, but must satisfy themselves by inspection or otherwise as to their accuracy. We have not carried out a detailed survey nor tested the services, appliances and specific fittings. Room sizes should not be relied upon for carpets and furnishings. The measurements given are approximate. No person in this firm's employment has the authority to make or give any representation or warranty in respect of the property.

