



Websters  
estate agents



# Old Farm Road, Hampton, TW12 3QT

Detached 3 bedroom Bungalow with driveway parking and a south facing garden. Situated in a desirable residential private road just 0.4 miles from Hampton Infants and Buckingham Primary and less than 0.8 miles from Carlisle Primary, Hampton Boys and Lady Eleanor Hollis Schools.

With no onward chain, in need of some updating and currently offering 926 sq ft of well balanced living space with potential to substantially extend and reconfigure the layout to create a bespoke family home (subject to Planning Permission and Building Regulations)

Entrance hallway leads to 2 bedrooms at the front, the bathroom and the living room with double doors into the conservatory and the separate fitted kitchen. An internal lobby area with storage leads to the guest bedroom with built in wardrobes and an en-suite bathroom. Doors in the conservatory open directly onto the large 66 ft L shaped garden with lawn, mature planting and shed storage.

Located 0.3 miles from local shops and Hatherop Park and 0.8 miles from Hampton Village shops, restaurants and train station.  
EPC Rating D

- Detached Bungalow
- 3 Bedrooms and 2 Bathrooms
- No Onward Chain
- South Facing Garden and Driveway Parking
- Potential to Extend and Reconfigure the Layout (stpp)
- Desirable Private Road Location
- Close to Popular Schools



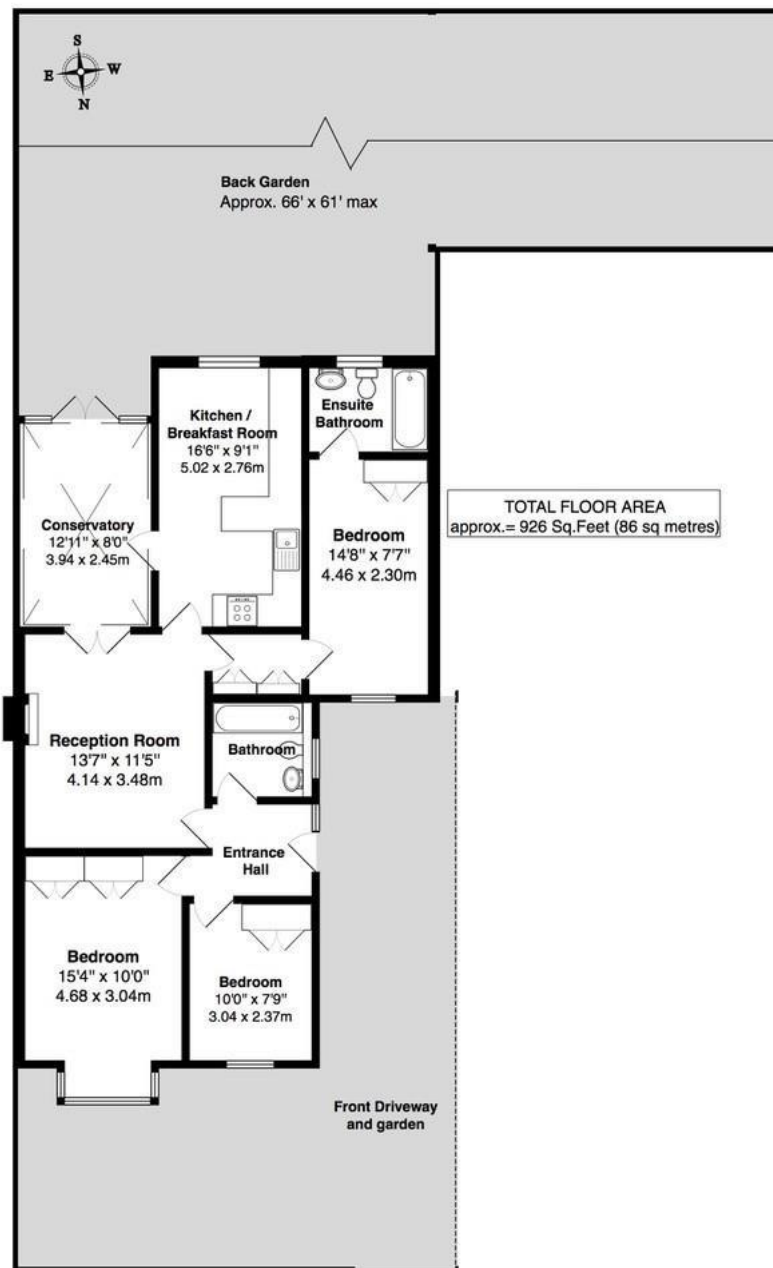

**a** Websters Estate Agents 164 Heath Road, Twickenham, Middlesex TW1 4BN

**t** 020 8892 3343

**e** sales@mywebsters.co.uk **w** mywebsters.co.uk

**Disclaimer**

These particulars, whilst believed to be accurate are set out as a general outline only for guidance and do not constitute any part of an offer or contract. Intending purchasers should not rely on them as statements of representation of fact, but must satisfy themselves by inspection or otherwise as to their accuracy. We have not carried out a detailed survey nor tested the services, appliances and specific fittings. Room sizes should not be relied upon for carpets and furnishings. The measurements given are approximate. No person in this firm's employment has the authority to make or give any representation or warranty in respect of the property.



