



I never read.  
I just look  
at pictures.  
  
Andy Warhol  
  
Moderna Museet,  
Stockholm Sweden  
10/2-17/3 1968

Websters  
estate agents



# Hamilton Road, Twickenham, TW2 6SN

Mid Terrace 2 double bedroom Victorian home with a south west facing garden. Situated in a quiet cul-de-sac location only 0.2 miles from Twickenham Green, local shops, bars and restaurants, less than 0.6 miles from St Richard Reynolds, Archdeacon and Trafalgar Primary and 0.8 miles from Waldegrave Girls School/ Co-ed Sixth Form.

Immaculately presented to offer 797 sq ft of stunning contemporary living space over 2 floors with high specification fixtures, fittings and floorings, sash windows, charming period features and modern stylish decor throughout.

Front door opens into the dual aspect living room with wood flooring, a feature fireplace, space for seating and dining and a door into the stylish fitted kitchen with some integrated appliances, a tiled floor and a velux roof window. A door at the side opens onto the low maintenance garden with space for seating, storage and secure gated rear access. On the first floor are 2 double bedrooms with built in storage and the luxury family bathroom.

Located only 0.6 miles from Church Street, the River Thames and towpath walks past Marble Hill Park into Richmond and just 0.7 miles from Strawberry Hill and Twickenham mainline train stations.

EPC Rating D

- Mid Terrace Victorian Family Home
- 2 Bedrooms and Upstairs Bathroom
- Contemporary Stylish Design
- Open Plan Living Space
- High Specification Throughout
- 0.2 Miles from Twickenham Green
- 0.7 Miles from Twickenham Mainline Station



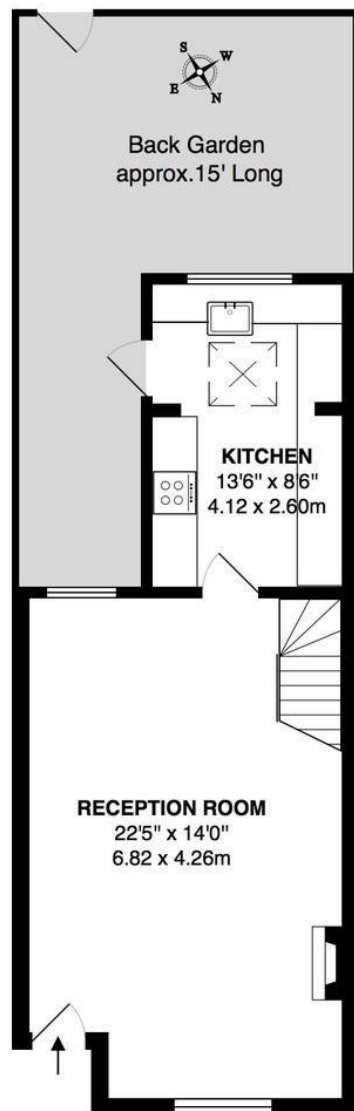

**GROUND FLOOR**



**FIRST FLOOR**

**TOTAL FLOOR AREA approx.= 797 Sq.Feet (74 sq.metres)**



