



076

Websters
estate agents

Waverley Avenue,Whitton,TW2 6DJ

Semi Detached Bungalow with driveway parking and a south facing garden. Situated just 0.1 mile from local shops, 0.6 miles from Heathfield and Bishop Perrin Primary Schools and 1 mile from Whitton town centre and mainline train station.

Well proportioned 1216 sq ft of living space over 1 floor with pull down ladder access to a useable loft/hobby room. Offering potential to create a bespoke family home by extending, fully loft converting and reconfiguring the layout (subject to Planning Permission and Building Regulations).

Front porch opens into the hallway with doors to the 2 double bedrooms, the shower room, the living room/conservatory and the dining room with access into the kitchen. This spacious room has fitted units, a dining table and a door into the utility and store room. Doors in the conservatory open onto the 68 ft landscaped garden with patios, lawn, mature planting and shed storage. A pull down ladder in the hall leads up to the loft room with power, a velux roof window and extensive eaves storage.

Located less than 0.3 miles from Heathfield Recreation Park and Crane Park with towpath bike and walking tracks along the River Crane and 0.7 miles from the A316 with direct access to the M3/M25 and into central London.

EPC Rating E

- Semi Detached Bungalow
- Landscaped South Facing Garden
- 1216 Sq Ft of Living Space
- Potential to Extend, Loft Convert and Reconfigure the Layout
- Loft/Hobby Room
- Driveway Parking for 2 Cars
- 0.1 Mile from Local Shops



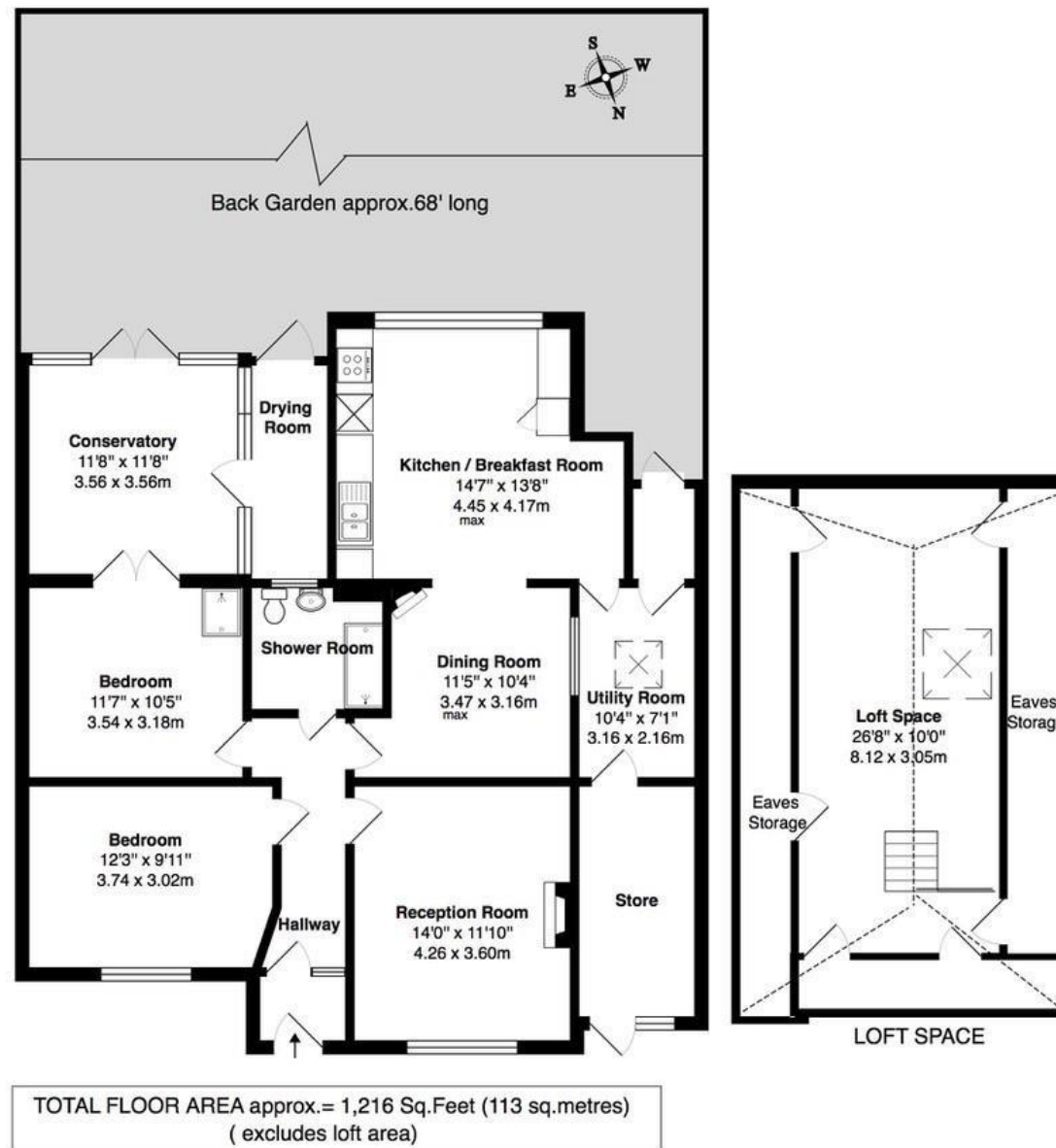

a Websters Estate Agents 164 Heath Road, Twickenham, Middlesex TW1 4BN

t 020 8892 3343

e sales@mywebsters.co.uk w mywebsters.co.uk

Disclaimer

These particulars, whilst believed to be accurate are set out as a general outline only for guidance and do not constitute any part of an offer or contract. Intending purchasers should not rely on them as statements of representation of fact, but must satisfy themselves by inspection or otherwise as to their accuracy. We have not carried out a detailed survey nor tested the services, appliances and specific fittings. Room sizes should not be relied upon for carpets and furnishings. The measurements given are approximate. No person in this firm's employment has the authority to make or give any representation or warranty in respect of the property.

