



Websters  
estate agents



# Manor Road, Twickenham, TW2 5DL

Ground Floor 2 bedroom apartment in a popular purpose built development with residents parking and well maintained communal gardens. Situated only 0.3 miles from Crane Park and 0.5 miles from Twickenham Green, local shops, bars and restaurants.

Refurbished by the current owners to an impressive standard to offer 581 sq ft of well proportioned living space with modern fixtures, fittings and floorings, double glazed windows and doors and neutral decor throughout.

Entrance hallway leads to the 2 bedrooms, the master with built in wardrobes, the spacious living room with a feature fireplace, the stylish fitted bathroom and the westerly aspect kitchen/breakfast room with wood flooring, contemporary unfitted units, space for dining and a door directly onto the communal gardens.

Located 0.8 miles from Strawberry Hill train station and the A316 with direct access to the M3/M25 and into central london and only 1 mile from Twickenham town centre.  
EPC Rating C

- Ground Floor Apartment
- 2 Double Bedrooms
- Recently Extended Lease
- Kitchen Door Directly onto Communal Gardens
- Stylish Family Bathroom
- Living Room and Kitchen/Breakfast Room
- 0.5 Miles from Twickenham Green



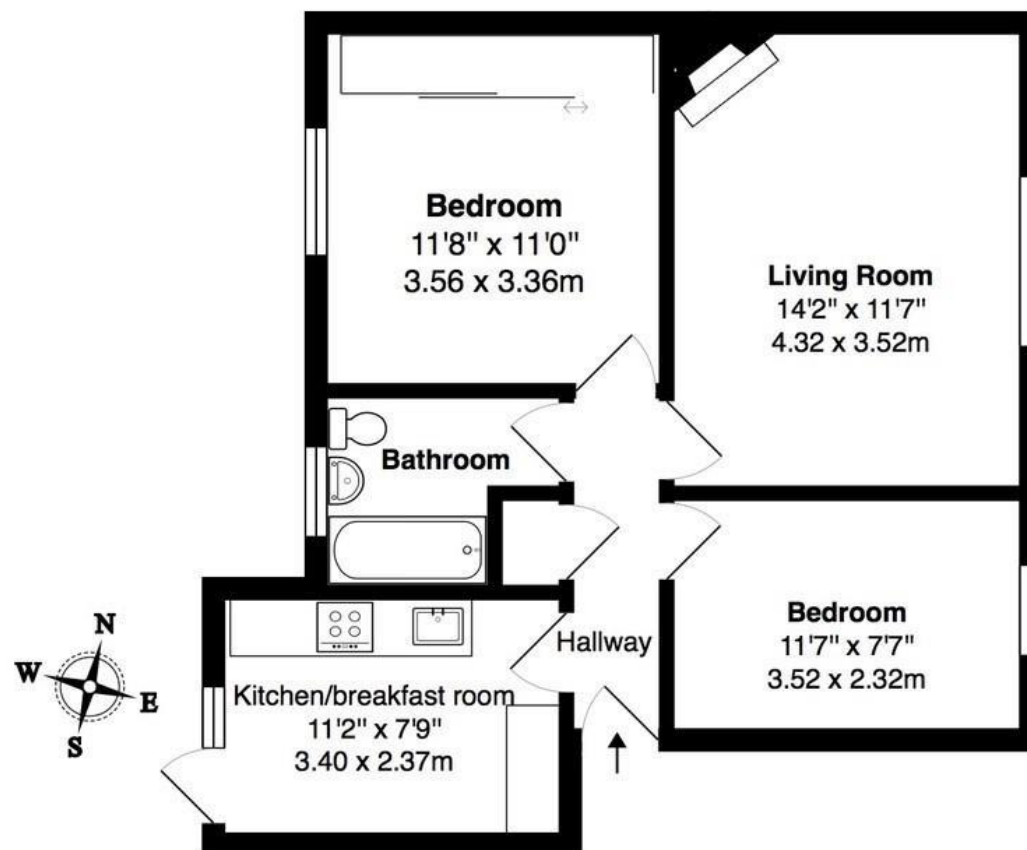

**TOTAL FLOOR AREA approx.= 581 Sq.Feet (54 sq.metres)**

**a** Websters Estate Agents 164 Heath Road, Twickenham, Middlesex TW1 4BN

**t** 020 8892 3343

**e** sales@mywebsters.co.uk **w** mywebsters.co.uk

**Disclaimer**

These particulars, whilst believed to be accurate are set out as a general outline only for guidance and do not constitute any part of an offer or contract. Intending purchasers should not rely on them as statements of representation of fact, but must satisfy themselves by inspection or otherwise as to their accuracy. We have not carried out a detailed survey nor tested the services, appliances and specific fittings. Room sizes should not be relied upon for carpets and furnishings. The measurements given are approximate. No person in this firm's employment has the authority to make or give any representation or warranty in respect of the property.



