



Websters
estate agents

Denmark Road, Twickenham, TW2 5EN

Mid Terrace Victorian 2 double bedroom cottage in a popular residential location just 0.4 miles from Twickenham Green and local shops and 0.5 miles from Fulwell and Strawberry Hill train stations.

Tastefully presented with modern fixtures, fittings and flooring, double glazed windows, charming period features, low maintenance courtyard garden and neutral decor throughout with potential to extend at the side on the ground floor (subject to Building Regulations and Planning Permission).

Front door opens into the living room with access to the kitchen/diner with a breakfast bar, views of the garden and a lobby area with doors to the bathroom, storage cupboard and onto the L-shaped garden. On the first floor are 2 bedrooms the master with built in cupboards and access to loft storage.

Located 0.2 miles from St James Primary, 0.4 miles from Stanley, Trafalgar and Archdeacon Primary Schools and just 0.1 mile from Waldegrave Girls School/Sixth Form.
EPC Rating D

- Mid Terrace Victorian Cottage
- 2 Bedrooms
- Popular Twickenham Location
- Modern Fixtures and Fittings
- Living Room and Kitchen/Diner
- Private Courtyard Garden
- 0.4 Miles from Twickenham Green

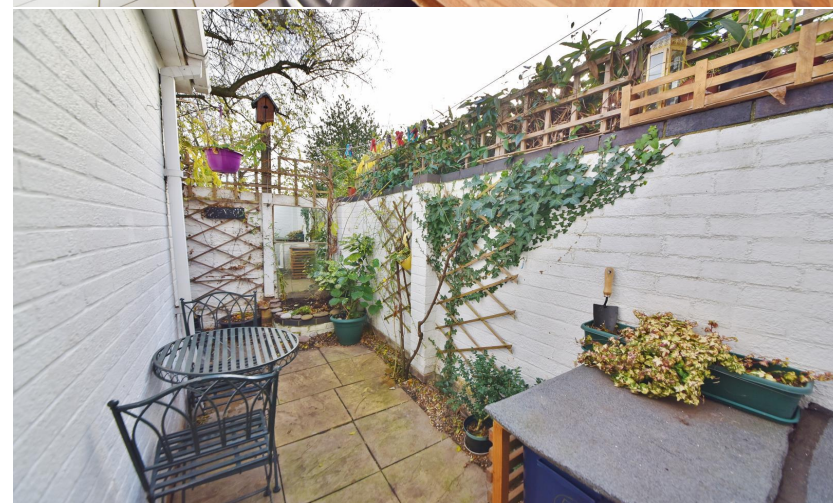



GROUND FLOOR
APPROX. FLOOR
AREA 282 SQ.FT.
(26.2 SQ.M.)

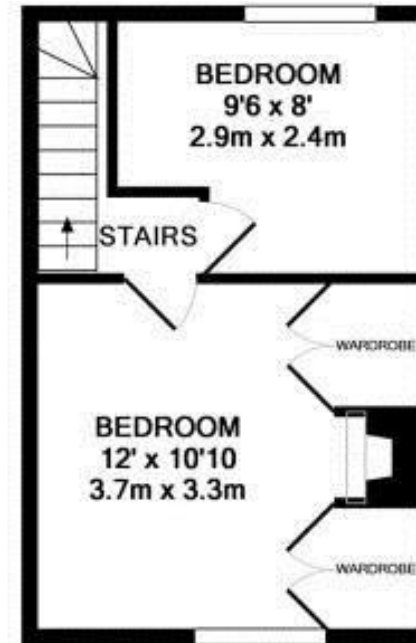

1ST FLOOR
APPROX. FLOOR
AREA 225 SQ.FT.
(20.9 SQ.M.)

TOTAL APPROX. FLOOR AREA 507 SQ.FT. (47.1 SQ.M.)

a Websters Estate Agents 164 Heath Road, Twickenham, Middlesex TW1 4BN **t** 020 8892 3343 **e** sales@mywebsters.co.uk **w** mywebsters.co.uk

Disclaimer
These particulars, whilst believed to be accurate are set out as a general outline only for guidance and do not constitute any part of an offer or contract. Intending purchasers should not rely on them as statements of representation of fact, but must satisfy themselves by inspection or otherwise as to their accuracy. We have not carried out a detailed survey nor tested the services, appliances and specific fittings. Room sizes should not be relied upon for carpets and furnishings. The measurements given are approximate. No person in this firm's employment has the authority to make or give any representation or warranty in respect of the property.

