



SUNNINGDALE COURT

Websters
estate agents

Whitton Dene, Hounslow, TW3 2JR

Ground Floor 1 double bedroom apartment with a private front door, enclosed garden, visitors parking and a garage. Situated 0.3 miles from Hounslow Station, 0.7 miles from Whitton Station and 0.6 miles from Whitton and Hounslow Town Centres.

With vacant possession and no onward chain, this well proportioned property offers 470 sq ft of living space with double glazed windows and doors, a modern fitted kitchen and bathroom and built in storage. Possibility for the new owner to extend the lease which currently has 78 years remaining (details available on request)

Front door at the side of the property opens into the hallway with doors to the double bedroom, bathroom, storage and the living/dining room. This spacious room has a door into the fitted kitchen and patio doors onto the private decked garden with gated rear access to the garage area.

Located just 0.2 miles from Murray Park and less than 0.5 miles from historic Kneller Hall.
EPC Rating C

- Ground Floor 1 Bedroom Apartment
- Vacant Possession and No Chain
- Private Entrance, Garden and Garage
- Currently 78 Year Lease
- Living/Dining Room and Separate Kitchen
- Double Bedroom
- 0.6 Miles from Whitton Town Centre



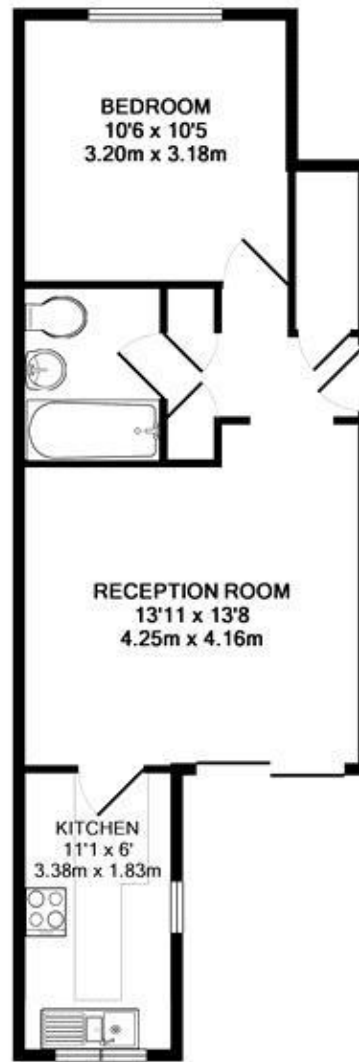

SUNNINGDALE COURT, WHITTON DENE, TW3 2JR
TOTAL APPROX. FLOOR AREA 470 SQ.FT. (43.6 SQ.M.)

a Websters Estate Agents 164 Heath Road, Twickenham, Middlesex TW1 4BN **t** 020 8892 3343 **e** sales@mywebsters.co.uk **w** mywebsters.co.uk

Disclaimer

These particulars, whilst believed to be accurate are set out as a general outline only for guidance and do not constitute any part of an offer or contract. Intending purchasers should not rely on them as statements of representation of fact, but must satisfy themselves by inspection or otherwise as to their accuracy. We have not carried out a detailed survey nor tested the services, appliances and specific fittings. Room sizes should not be relied upon for carpets and furnishings. The measurements given are approximate. No person in this firm's employment has the authority to make or give any representation or warranty in respect of the property.

