



Resident
permit
holders
only

700

Websters
estate agents

Laurel Avenue, Twickenham, TW1 4HZ

Mid Terrace 3 double bedroom Victorian family home in a popular residential location just 0.2 miles from Twickenham Green, Town Centre shops, bars and restaurants and just 0.5 miles from Twickenham mainline train station.

No Onward Chain

Recently extended on the ground floor to offer 1324 sq ft of well proportioned living space over 3 floors with high specification fixtures, fittings and flooring, charming period features, built in storage, double glazed windows and doors and tasteful decor throughout.

Entrance hallway leads to the bay fronted living room and the kitchen/dining/family room at the rear. Full width folding doors open onto the garden with 2 decked areas, a lawn, shed storage and gated rear access. On the first floor are 2 bedrooms and the family bathroom with stairs up to the master bedroom with an en-suite shower room and storage.

Located 0.4 miles from Archdeacon Primary and St Richard Reynolds School, 0.6 miles from Trafalgar Infants and just 0.8 miles from Waldegrave Girls School/Co-ed Sixth Form.
EPC Rating D

- Mid Terrace Victorian Family Home
- 3 Double Bedrooms
- Family Bathroom and En-Suite Shower Room
- Stunning Kitchen/Family Room
- Central Twickenham Location
- Separate Living Room
- 0.5 Miles from Twickenham Mainline Station



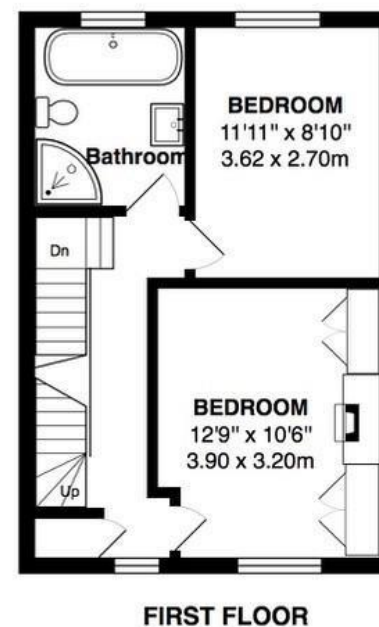

TOTAL FLOOR AREA approx.= 1,324 Sq.Feet (123 sq.metres)

a Websters Estate Agents 36 Broad Street, Teddington, Middlesex TW11 8QY

t 020 8614 6000

e sales@mywebsters.co.uk **w** mywebsters.co.uk

Disclaimer

These particulars, whilst believed to be accurate are set out as a general outline only for guidance and do not constitute any part of an offer or contract. Intending purchasers should not rely on them as statements of representation of fact, but must satisfy themselves by inspection or otherwise as to their accuracy. We have not carried out a detailed survey nor tested the services, appliances and specific fittings. Room sizes should not be relied upon for carpets and furnishings. The measurements given are approximate. No person in this firm's employment has the authority to make or give any representation or warranty in respect of the property.

