



Websters
estate agents

Websters
estate agents

Campbell Road, Twickenham, TW2 5BY

Mid Terrace 3 bedroom Victorian family home in a quiet cul-de-sac location just 0.2 miles from Trafalgar Nursery and Primary School and less than 0.5 miles from Archdeacon Primary and Waldegrave Girls Secondary/Sixth Form.

Extended to the rear, loft converted and refurbished to an impressive standard to offers 1102 sq ft of light filled living space over 3 floors. Tastefully presented throughout with high specification fixtures, fittings, flooring and lighting and double glazed windows and doors.

Entrance hallway leads into dual aspect living room with a door into the dining room and the kitchen at the rear. Doors open onto the 60ft south west facing garden with a patio, lawn and shed storage. On the first floor are 2 bedrooms and the family bathroom with stairs up to the master bedroom with an en suite shower room and eaves storage.

With unrestricted road parking and located 0.3 miles from Twickenham Green, local shops and restaurants and 0.8 miles from Strawberry Hill Station.

EPC Rating E

- Mid Terrace Victorian Family Home
- 3 Bedrooms and 2 Bathrooms
- Extended and Loft Converted
- South West Facing Garden
- Spacious Living Room and Kitchen/Family Room
- Popular Cul-de-Sac Location
- 0.8 Miles from Strawberry Hill Station



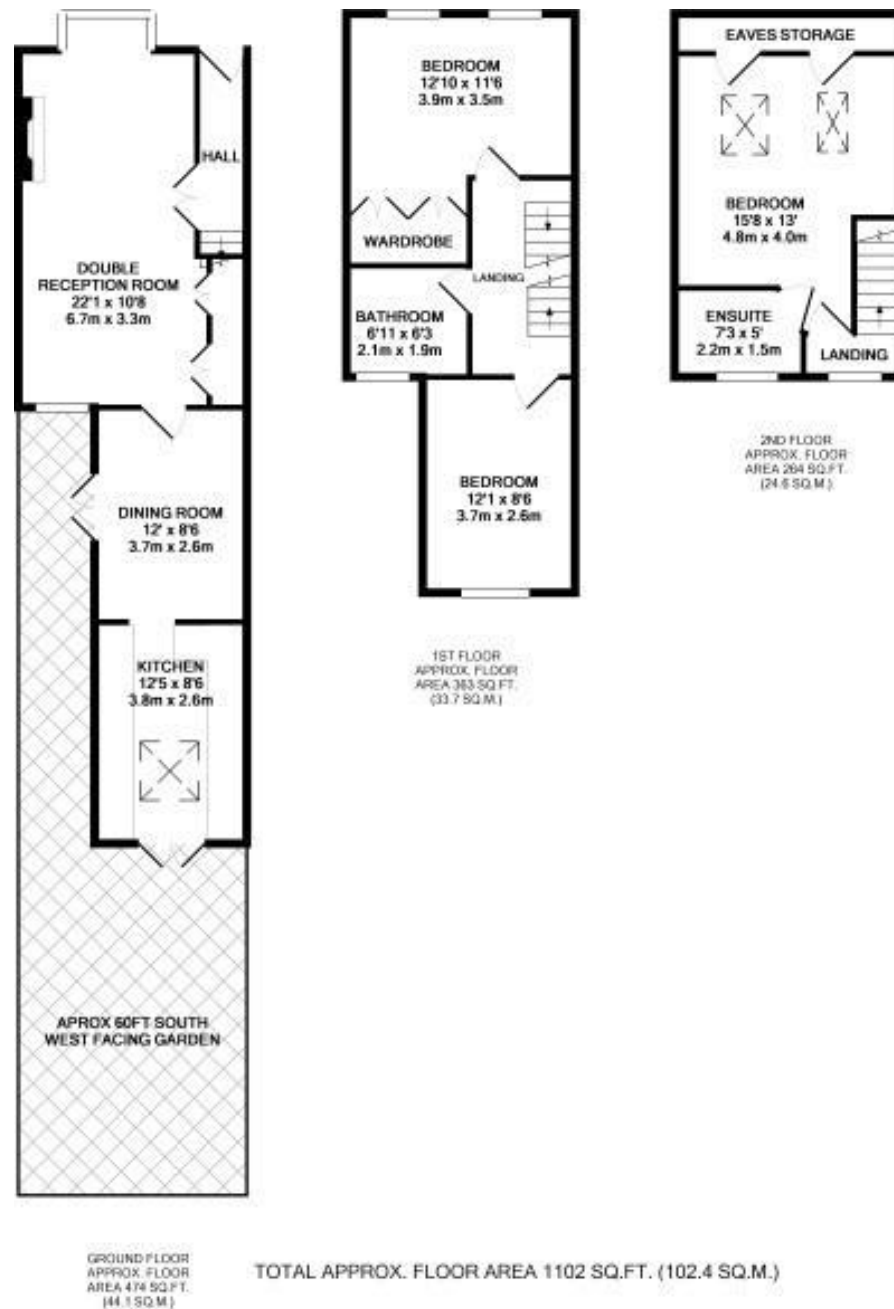

a Websters Estate Agents 164 Heath Road, Twickenham, Middlesex TW1 4BN

t 020 8892 3343

e sales@mywebsters.co.uk **w** mywebsters.co.uk

Disclaimer

These particulars, whilst believed to be accurate are set out as a general outline only for guidance and do not constitute any part of an offer or contract. Intending purchasers should not rely on them as statements of representation of fact, but must satisfy themselves by inspection or otherwise as to their accuracy. We have not carried out a detailed survey nor tested the services, appliances and specific fittings. Room sizes should not be relied upon for carpets and furnishings. The measurements given are approximate. No person in this firm's employment has the authority to make or give any representation or warranty in respect of the property.

