



Websters  
estate agents



# River Way, Twickenham, TW2 5JP

Semi detached 3 bedroom family home in a popular residential location with driveway parking for 2 cars. Situated 0.1 mile from Crane Park and 0.8 miles from Whitton town centre and mainline train station.

In good decorative order throughout, this pleasing home offers 1001 sq ft of well proportioned living space over 2 floors with the potential to extend/re-configure the layout and loft convert (subject to Planning Permission and Building Regulations) to create a bespoke family home.

Entrance hallway leads into the dual aspect open plan living/family room and the fitted kitchen. Doors from both rooms lead into the conservatory style extension at the rear with direct access onto the rear garden. With mature planting, lawn and a large storage shed, this lovely garden has gated side access to the front of the property/driveway. On the first floor are 3 good sized bedrooms, the family bathroom and access to loft storage.

Located less than 0.8 miles from Trafalgar Primary, Heathfield Primary and Waldegrave Girls Secondary Schools and just 0.1 mile from the A316 with direct access to the M3/M25 and central London.

EPC Rating E

- Semi Detached Family Home
- 3 Bedrooms and Upstairs Bathroom
- Potential to Extend and Loft Convert (stpp)
- 2 Living Areas and Separate Kitchen
- Popular Residential Twickenham Location
- Driveway Parking for 2 Cars
- 0.8 Miles from Whitton Mainline Train Station



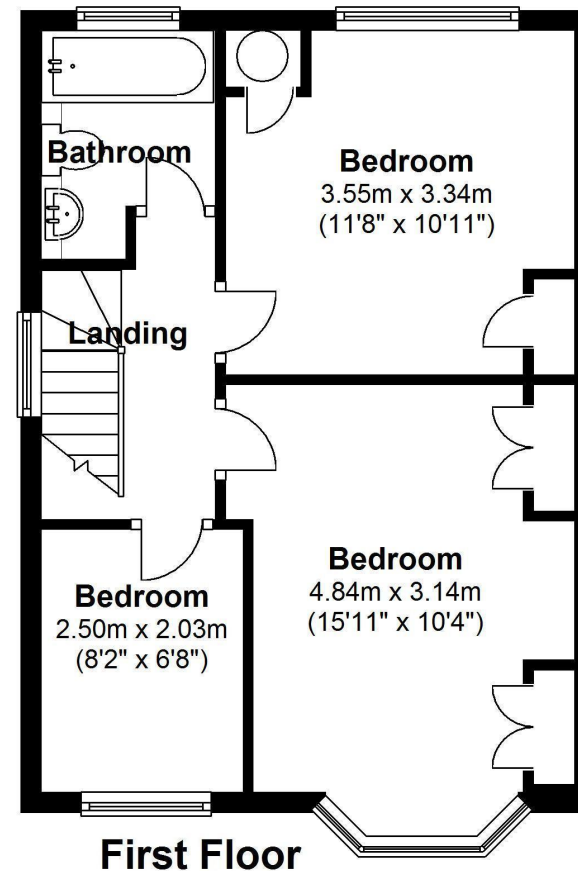
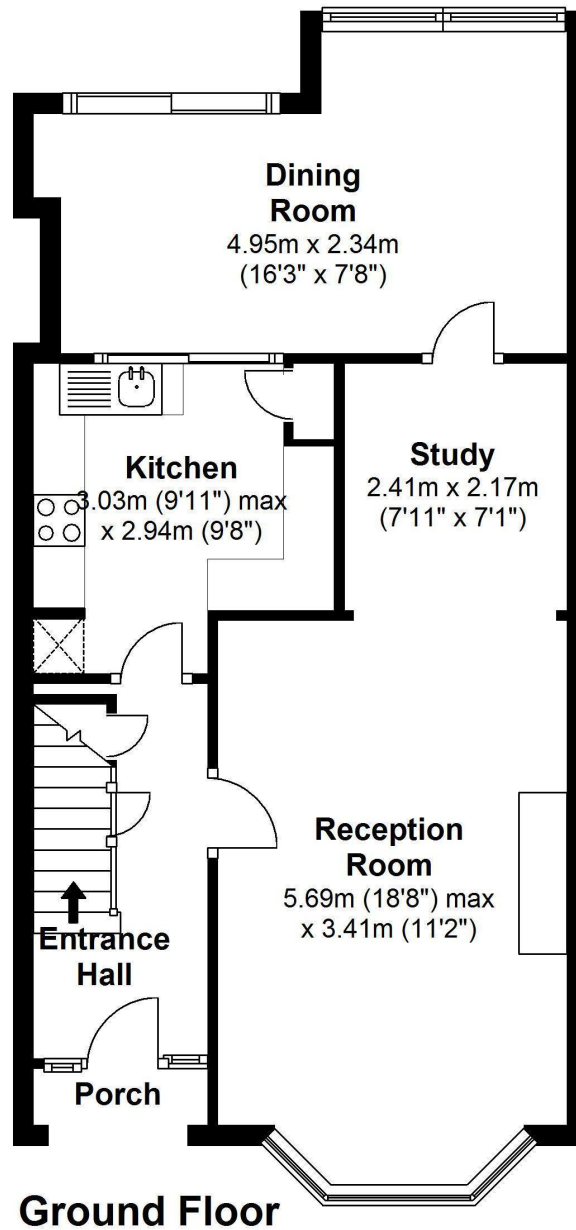

Total Floor Area approx.= 1,001 Sq.Feet (93 sq.metres)

**Disclaimer**

These particulars, whilst believed to be accurate are set out as a general outline only for guidance and do not constitute any part of an offer or contract. Intending purchasers should not rely on them as statements of representation of fact, but must satisfy themselves by inspection or otherwise as to their accuracy. We have not carried out a detailed survey nor tested the services, appliances and specific fittings. Room sizes should not be relied upon for carpets and furnishings. The measurements given are approximate. No person in this firm's employment has the authority to make or give any representation or warranty in respect of the property.



