



Websters  
estate agents



# Thames Street, Hampton, TW12 2DX

End of Terrace Grade II Listed Georgian Cottage with second floor views across the River Thames. Situated 0.3 miles from Hampton Village Green and local shops and 0.5 miles from Hampton Train Station.

Freehold property offering 936 sq ft of well proportioned living space over 3 floors with modern fixtures and fittings and charming period features. Situated just 150 metres from Benn's Alley leading to the River Thames and Hampton Sailing Club.

Gated entrance to the side of the property leads to the covered front door with access into the large hallway with storage and a study area. Doors open into the living room with wood flooring, feature fireplace and plantation shutters. To the rear is the kitchen/dining room with fitted units and doors into the pretty courtyard area. On the first floor is a double bedroom and the period style family bathroom with stairs up to the second bedroom with an en-suite shower room and views across the Thames.

Located within 0.5 miles of Hampton Junior, Twickenham Prep, Athelstan House and Denmead School and 0.4 miles from Bushy Park and Hampton outdoor swimming pool.

EPC Rating E

- Grade II Listed Georgian Cottage
- 2 Double Bedrooms and 2 Bathrooms
- Living Room and Separate Kitchen/Dining Room
- Internal Courtyard Garden and River Views
- 936 Sq Ft of Living Space over 3 Floors
- Well Presented Freehold Property
- 0.5 Miles from Hampton Train Station
- Just 150 Metres from River Thames





GROUND FLOOR  
APPROX. FLOOR  
AREA 390 SQ.FT.  
(36.2 SQ.M.)



1ST FLOOR  
APPROX. FLOOR  
AREA 312 SQ.FT.  
(29.0 SQ.M.)

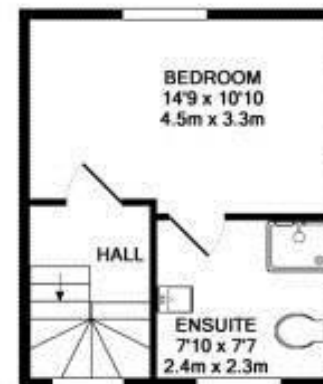

2ND FLOOR  
APPROX. FLOOR  
AREA 235 SQ.FT.  
(21.8 SQ.M.)

THAMES ST  
TOTAL APPROX. FLOOR AREA 936 SQ.FT. (87.0 SQ.M.)

**a** Websters Estate Agents 36 Broad Street, Teddington, Middlesex TW11 8QY

**t** 020 8614 6000

**e** sales@mywebsters.co.uk **w** mywebsters.co.uk

**Disclaimer**

These particulars, whilst believed to be accurate are set out as a general outline only for guidance and do not constitute any part of an offer or contract. Intending purchasers should not rely on them as statements of representation of fact, but must satisfy themselves by inspection or otherwise as to their accuracy. We have not carried out a detailed survey nor tested the services, appliances and specific fittings. Room sizes should not be relied upon for carpets and furnishings. The measurements given are approximate. No person in this firm's employment has the authority to make or give any representation or warranty in respect of the property.



