



Websters
estate agents

Andover Rd, Twickenham, TW2 6PB

End of Terrace 4 bedroom Victorian house on a popular residential road with side access to the rear garden. Situated 0.2 miles from Twickenham Green, local shops and restaurants and just 0.7 miles from Strawberry Hill Station.

Extended, loft converted and fully refurbished to an impressive standard with high quality fixtures, fittings and flooring, a new boiler, central heating, and electrics, underfloor heating in bathrooms, new double glazed windows/doors and light neutral decor throughout. This delightful family home offers 1213 sq ft light and airy well balanced living space over 3 floors.

Entrance hallway leads to the living room with wood flooring and a feature fireplace, a w.c/utility room and the dining/family room and kitchen at the rear. This stunning room has space for seating and a dining table and a fully integrated kitchen with granite worktops. Folding doors open onto the south facing garden with sun deck, lawn, fully powered summer house/home office and lockable gated side access.

On the first floor are 3 bedrooms and the luxury family bathroom with stairs up to the master bedroom with a juliet balcony, fabulous 4 piece bathroom and eaves storage.

Located 0.3 miles from Archdeacon and Trafalgar Primary Schools and only 0.6 miles from St Richard Reynolds and Waldegrave Girls School/Sixth Form.

EPC Rating D

- End of Terrace Victorian Family Home
- Newly Refurbished, Extended and Loft Converted
- South Facing Garden with Summer House/Home Office
- 4 Bedrooms and 2 Luxury Bathrooms
- High Specification Throughout
- 0.7 Miles to Strawberry Hill Station
- 0.3 Miles to Trafalgar and Archdeacon Primary Schools



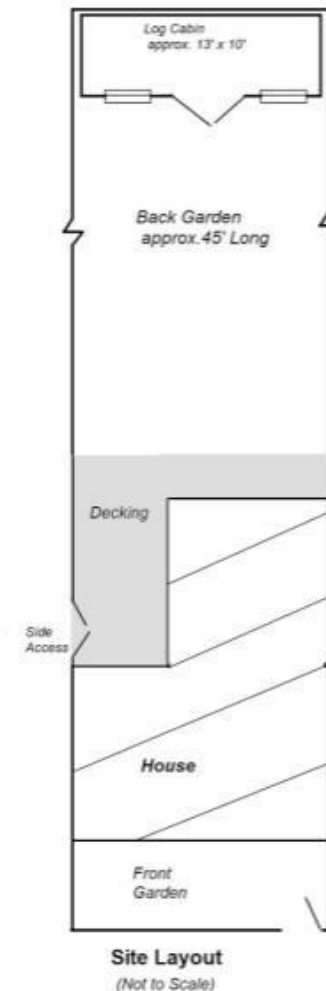
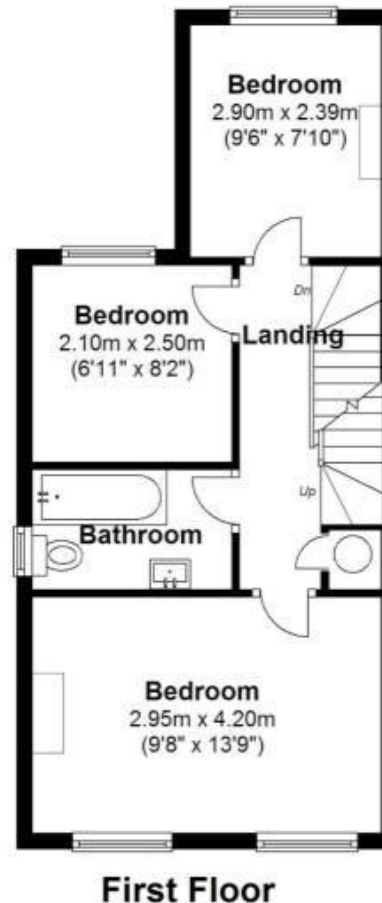
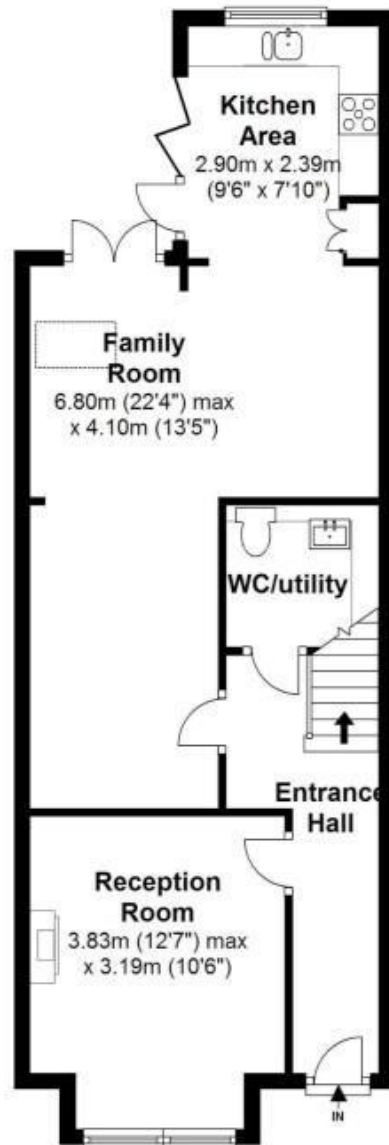

Total Floor Area approx. = 1,213 Sq. Feet (112.7 sq. metres)

EPCertificate.com

Disclaimer

These particulars, whilst believed to be accurate are set out as a general outline only for guidance and do not constitute any part of an offer or contract. Intending purchasers should not rely on them as statements of representation of fact, but must satisfy themselves by inspection or otherwise as to their accuracy. We have not carried out a detailed survey nor tested the services, appliances and specific fittings. Room sizes should not be relied upon for carpets and furnishings. The measurements given are approximate. No person in this firm's employment has the authority to make or give any representation or warranty in respect of the property.

