



Websters
estate agents

Worton Road, Isleworth, TW7 6HQ

Situated in Isleworth, this newly refurbished 3 bedroom end of terrace family home has wooden flooring, carpets and fittings throughout. Luxury upstairs bathroom and downstairs W.C/utility room.

The modern fully fitted kitchen and through lounge are complimented by views of the garden. The rear deck and 55ft lawned garden can be accessed via the side of the house and there is a useful shed for storage. The driveway provides off street parking for 2 cars.

Potential to extend to the side and rear of the property and convert the loft space (subject to usual planning requirements), gives this property great appeal and potential.

- Newly Refurbished
- 3 Bedroom End of Terrace
- 26ft Through Lounge
- Double Glazed & Gas Central Heating
- Downstairs W.C & Utility Room
- Luxury Bathroom with Separate Shower Cubicle
- Fully Fitted Kitchen
- No Forward Chain
- Driveway Parking for 2 Cars



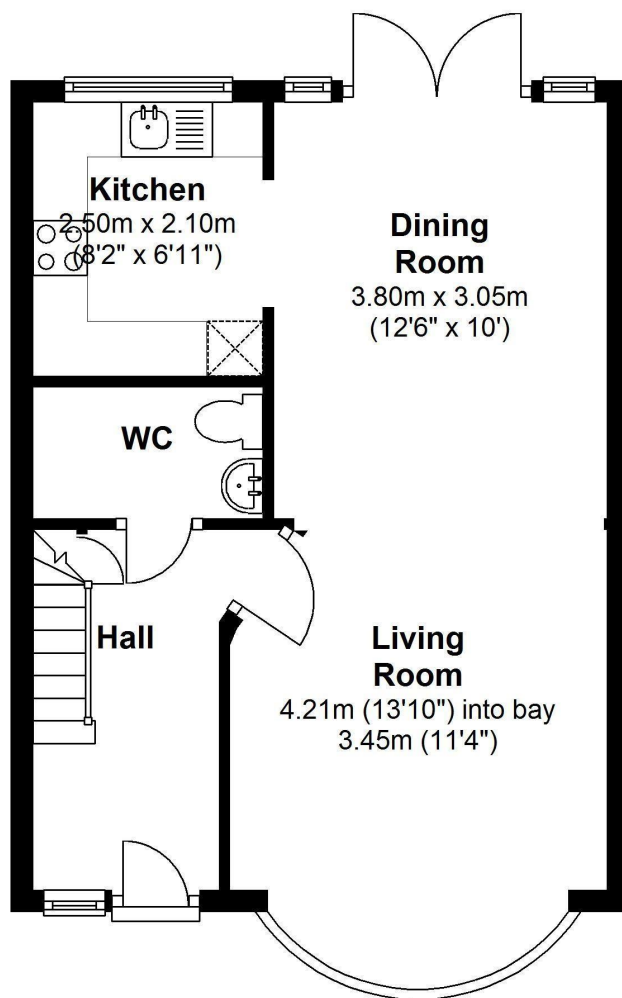

Ground Floor

Approx area 39.18 sq.metres (422 sq.feet)

Total Floor Area Approx. 78.36 sq.metres (844 sq.feet)

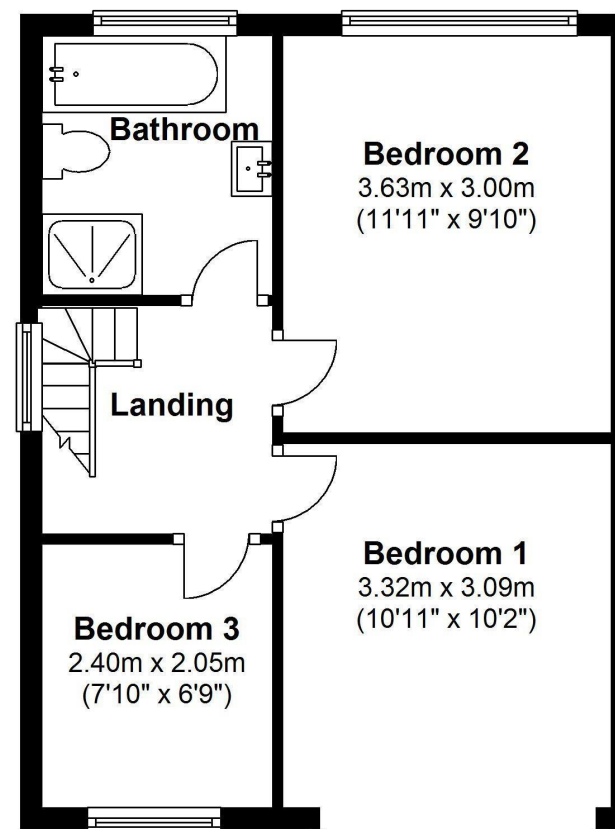

First Floor

Approx.area 39.18 sq.metres (422 sq.feet)

a Websters Estate Agents 36 Broad Street, Teddington, Middlesex TW11 8QY

t 020 8614 6000

e sales@mywebsters.co.uk **w** mywebsters.co.uk

Disclaimer

These particulars, whilst believed to be accurate are set out as a general outline only for guidance and do not constitute any part of an offer or contract. Intending purchasers should not rely on them as statements of representation of fact, but must satisfy themselves by inspection or otherwise as to their accuracy. We have not carried out a detailed survey nor tested the services, appliances and specific fittings. Room sizes should not be relied upon for carpets and furnishings. The measurements given are approximate. No person in this firm's employment has the authority to make or give any representation or warranty in respect of the property.

