



Websters
estate agents

44 Warwick Road, Twickenham, TW2 6SW

An attractive two bedroom Victorian Cottage beautifully presented throughout with period features.

The ground floor features wooden floors and fire places with a bright and airy, open plan dining/living area. The well equipped, white modern kitchen leads out onto the west facing courtyard garden, with useful rear access.

Upstairs, two good sized double bedrooms along with an impressive luxury bathroom suite.

Warwick Road is located just 150 yards from Twickenham Green and less than a mile from Strawberry Hill and Twickenham mainline train stations.

- Attractive Victorian Cottage
- Two Double Bedrooms
- Open Plan Living/Dining Room
- Stunning Kitchen
- Luxury Upstairs Bathroom
- West Facing Courtyard Garden
- Superbly Presented - Period Character
- Twickenham Mainline Station 0.8 Miles



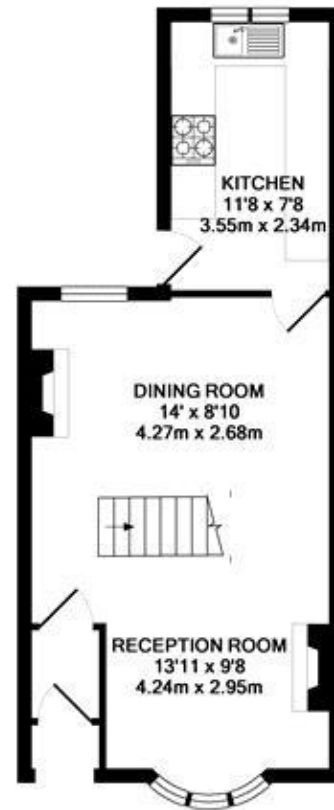

GROUND FLOOR
APPROX. FLOOR
AREA 405 SQ. FT.
(37.6 SQ. M.)



1ST FLOOR
APPROX. FLOOR
AREA 356 SQ. FT.
(33.1 SQ. M.)

WARWICK ROAD, TWICKENHAM, TW2 6SW
TOTAL APPROX. FLOOR AREA 761 SQ. FT. (70.7 SQ. M.)

All measurements taken to RICS Guidelines for Gross Internal Area. Whilst every attempt has been made to ensure the accuracy of the floor plan contained here, all measurements are approximate and no responsibility is taken for any error, omission or misstatement. This plan is for illustrative purposes only and should be used as such by any prospective purchaser. The services, systems and appliances shown have not been tested and no guarantee as to their operability or efficiency can be given.

Made with Mapbox ©2012



a Websters Estate Agents 36 Broad Street, Teddington, Middlesex TW11 8QY

t 020 8614 6000

e sales@mywebsters.co.uk **w** mywebsters.co.uk

Disclaimer

These particulars, whilst believed to be accurate are set out as a general outline only for guidance and do not constitute any part of an offer or contract. Intending purchasers should not rely on them as statements of representation of fact, but must satisfy themselves by inspection or otherwise as to their accuracy. We have not carried out a detailed survey nor tested the services, appliances and specific fittings. Room sizes should not be relied upon for carpets and furnishings. The measurements given are approximate. No person in this firm's employment has the authority to make or give any representation or warranty in respect of the property.

