



Websters
estate agents

Norcutt Road, Twickenham, TW2 6SR

Pretty 2 double bedroom Victorian cottage retaining period features, charm and character in the ever popular Twickenham Green area.

Arranged over 3 floors this house offers a well balanced 922 sq ft of accommodation.

Downstairs is light, inviting and spacious, with open plan living, dining and fitted kitchen. This stunning space incorporates modern with period features to give a contemporary but homely feel.

Upstairs are 2 double bedrooms, the bathroom and an appealing, west facing roof terrace garden, accessed from the 1st floor landing.

Located less than 1 mile from Twickenham Railway Station, local shops and schools.

- Pretty Victorian Cottage
- Twickenham Green Location
- Open Plan Living
- Over Three Floors
- 2 Double Bedrooms
- Period Character
- First Floor Bathroom
- West Facing Roof Garden



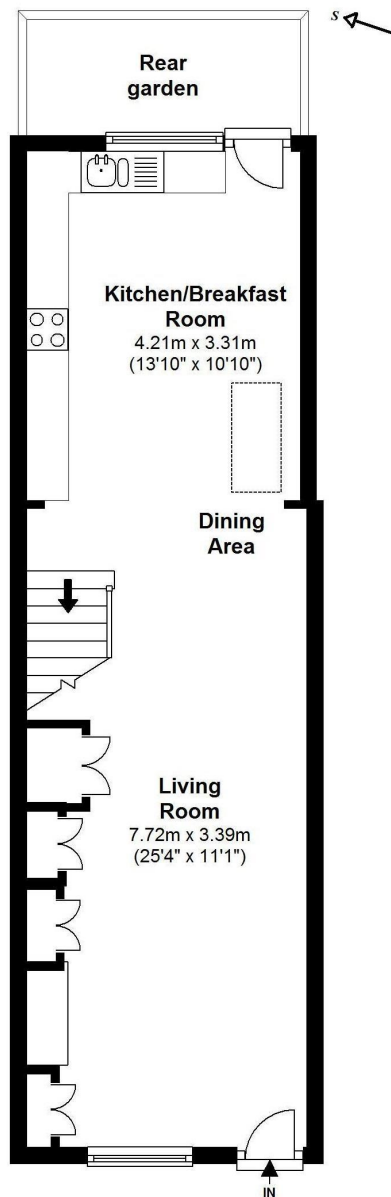

Approx. floor area = 432 Sq. Feet (40.11 sq.metres)

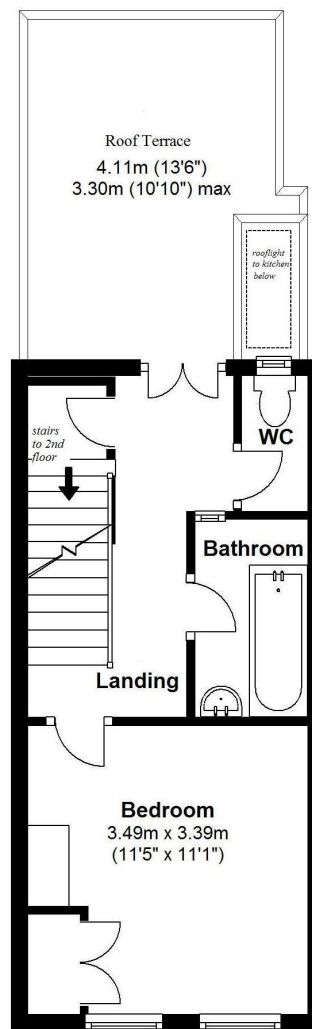

Approx. floor area = 282 Sq. Feet (26.17 sq.metres)

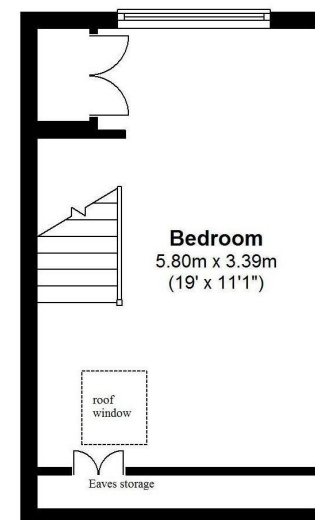

Approx. floor area = 208 Sq. feet (19.31 sq.metres)

Gross Floor Area approx. = 922 Sq. Feet (85.59 sq.metres)

a Websters Estate Agents 36 Broad Street, Teddington, Middlesex TW11 8QY

t 020 8614 6000

e sales@mywebsters.co.uk **w** mywebsters.co.uk

Disclaimer

These particulars, whilst believed to be accurate are set out as a general outline only for guidance and do not constitute any part of an offer or contract. Intending purchasers should not rely on them as statements of representation of fact, but must satisfy themselves by inspection or otherwise as to their accuracy. We have not carried out a detailed survey nor tested the services, appliances and specific fittings. Room sizes should not be relied upon for carpets and furnishings. The measurements given are approximate. No person in this firm's employment has the authority to make or give any representation or warranty in respect of the property.

