



Websters
estate agents

Meadway, Twickenham, TW2 6PG

Semi Detached 4 bedroom home with a south west facing garden. Situated just 0.1 mile from Trafalgar Nursery, less than 0.6 miles from Trafalgar Primary, Archdeacon Primary and Waldegrave Girls School/Co-ed Sixth Form and just 0.3 miles from Twickenham Green, local shops and restaurants.

With No Onward Chain and tastefully presented to offer 1382 sq ft of well proportioned living space over 2 floors with modern fixtures, fittings and floorings, double glazed windows and doors, neutral decor and potential to loft convert (subject to Planning Permission and Building Regulations)

Porch opens into the entrance hallway with doors to the fitted kitchen/breakfast room and the open plan living/dining room with access to the study/playroom. Patio doors in the living room and the kitchen open to the garden. On the first floor are 4 bedrooms and the family bathroom.

Located 0.5 miles from Whitton town centre and mainline train station, 0.7 miles from Strawberry Hill village and station and only 0.3 miles from the A316 with direct access to the M3/M25 and into central London.

EPC Rating D

- Semi Detached 4 Bedroom Home
- No Onward Chain
- Potential to Loft Convert (stpp)
- Option to Create Driveway Parking
- Currently 1382 Sq Ft of Living Space
- Within 0.6 Miles of Popular Schools
- 0.3 Miles from Twickenham Green



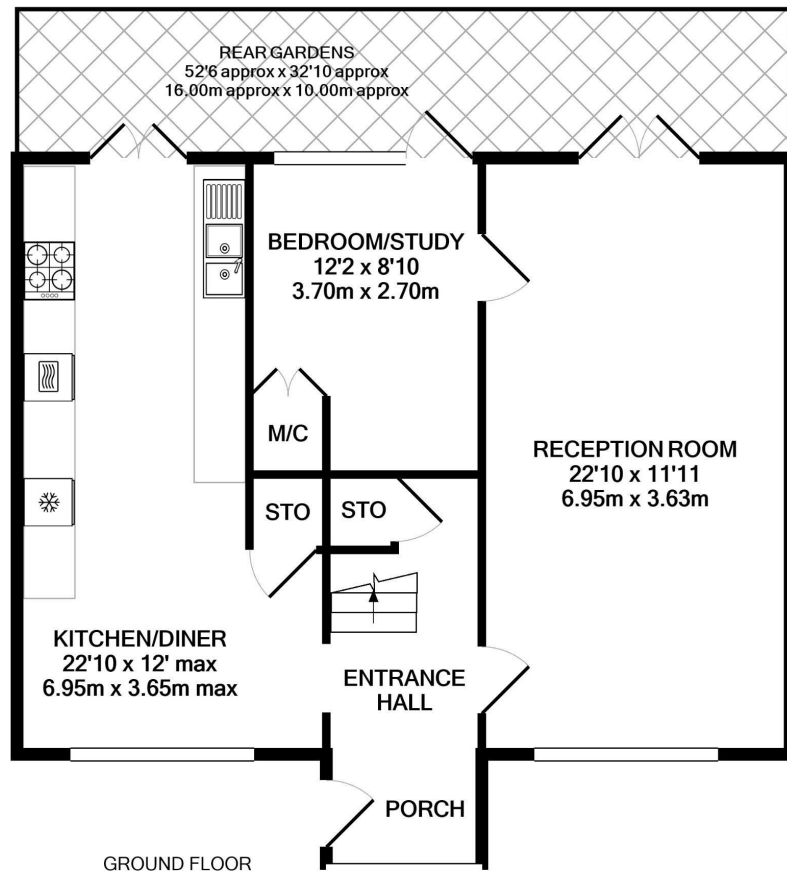

GROUND FLOOR
APPROX. FLOOR
AREA 705 SQ.FT.
(65.5 SQ.M.)

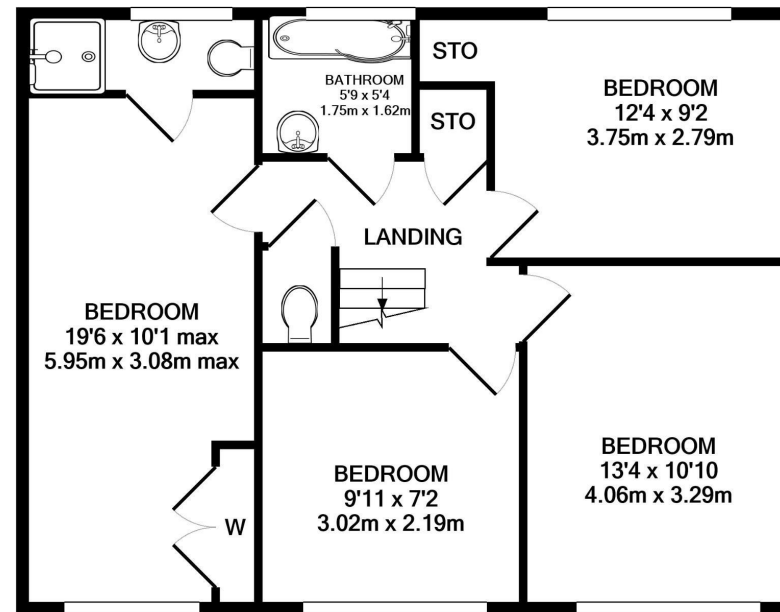

1ST FLOOR
APPROX. FLOOR
AREA 677 SQ.FT.
(62.9 SQ.M.)

TOTAL APPROX. FLOOR AREA 1382 SQ.FT. (128.4 SQ.M.)

