



Websters
estate agents

79c Churchview Road, Twickenham, TW2 5BX

Appealing and modern 2 double bedroom, mid terrace house built in a traditional style with a bright, open and contemporary feel.

Entrance hallway leads to a downstairs w.c, separate white fitted kitchen and the light and spacious open plan living/dining room. Doors open directly from the living area onto the west facing garden which benefits from a storage shed and pedestrian rear access. Upstairs are 2 double bedrooms and the modern family bathroom.

Situated on a popular residential road with driveway parking for one car and only 0.4 miles from Twickenham Green and local shops. EPC Rating C.

- Mid Terrace House
- 2 Double Bedrooms
- Upstairs Bathroom
- Downstairs W.C
- West Facing Garden with Rear Access
- Modern Fitted Kitchen
- Driveway Parking



Churchview Road

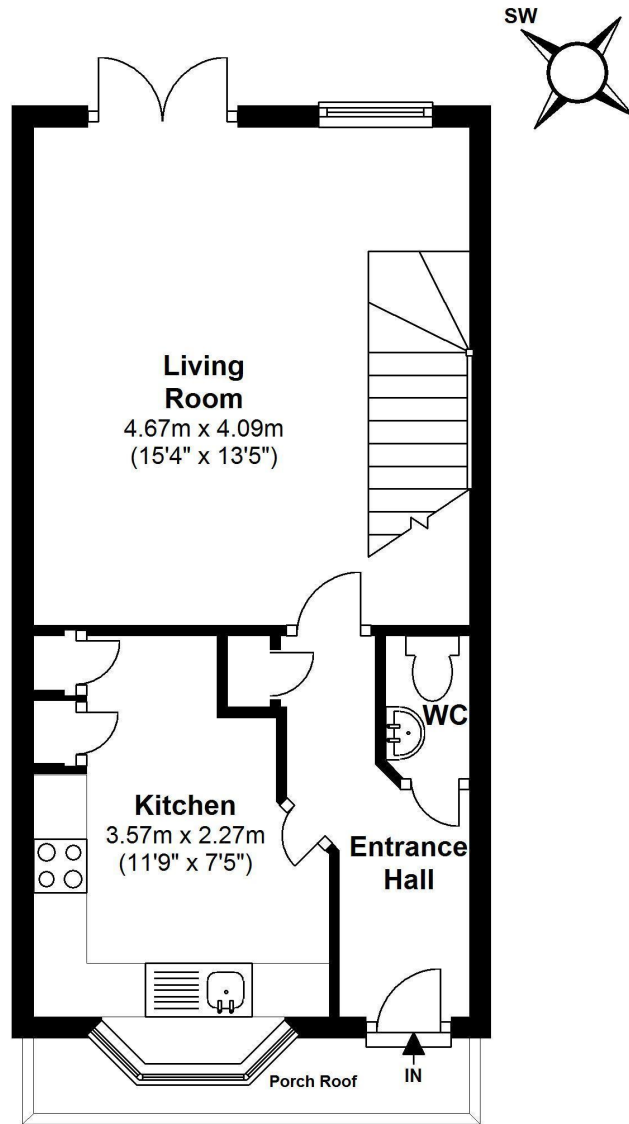

Ground Floor

Floor area approx.= 376 Sq.Feet (34.94 sq.metres)

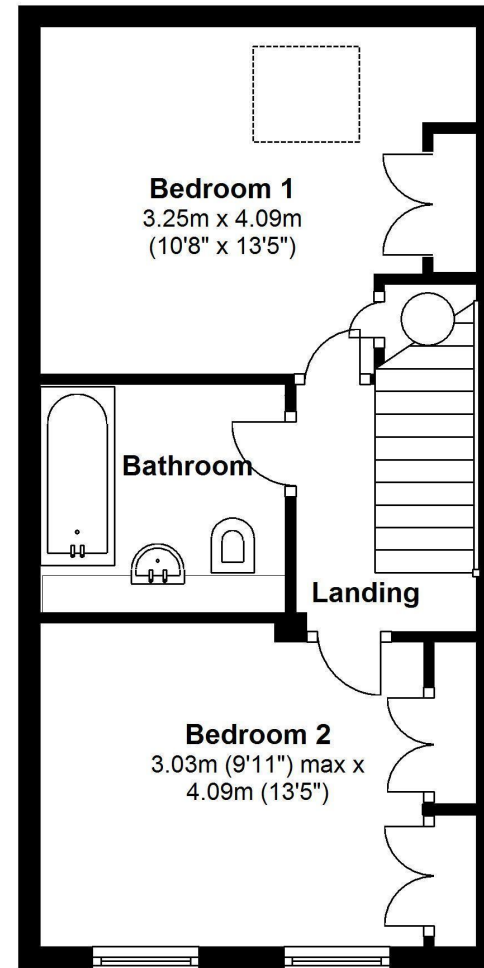

First Floor

Floor area approx.= 367 Sq.Feet (34.11 sq.metres)

Gross Floor Area approx.=743 Sq.Feet (69 sq.metres)

a Websters Estate Agents 36 Broad Street, Teddington, Middlesex TW11 8QY

t 020 8614 6000

e sales@mywebsters.co.uk **w** mywebsters.co.uk

Disclaimer

These particulars, whilst believed to be accurate are set out as a general outline only for guidance and do not constitute any part of an offer or contract. Intending purchasers should not rely on them as statements of representation of fact, but must satisfy themselves by inspection or otherwise as to their accuracy. We have not carried out a detailed survey nor tested the services, appliances and specific fittings. Room sizes should not be relied upon for carpets and furnishings. The measurements given are approximate. No person in this firm's employment has the authority to make or give any representation or warranty in respect of the property.

