



Websters  
estate agents



# 36 Second Cross Road, Twickenham, TW2 5RF

Best and final offers to be submitted by 12pm Monday 24th February.

Attractive end of terrace 2 double bedroom cottage in a popular location 0.2 miles from Twickenham Green and the local shops.

Recently refurbished throughout with a new boiler, kitchen, bathroom and floorings, this period property has a bright modern and welcoming feel.

The front door leads directly into the front reception/dining/kitchen area. A door at the rear opens into the second reception room which has direct access to the garden. Upstairs are 2 double bedrooms and the independently accessed bathroom.

Outside to the front is a small garden with a picket fence/gate and to the rear is a west facing paved courtyard style garden.

Situated 1 mile from Twickenham mainline train station and 0.5 miles from Strawberry Hill station.

- End of Terrace Period Cottage
- Newly Decorated Throughout
- 2 Reception Rooms
- 2 Double Bedrooms
- Upstairs Bathroom
- West Facing Garden



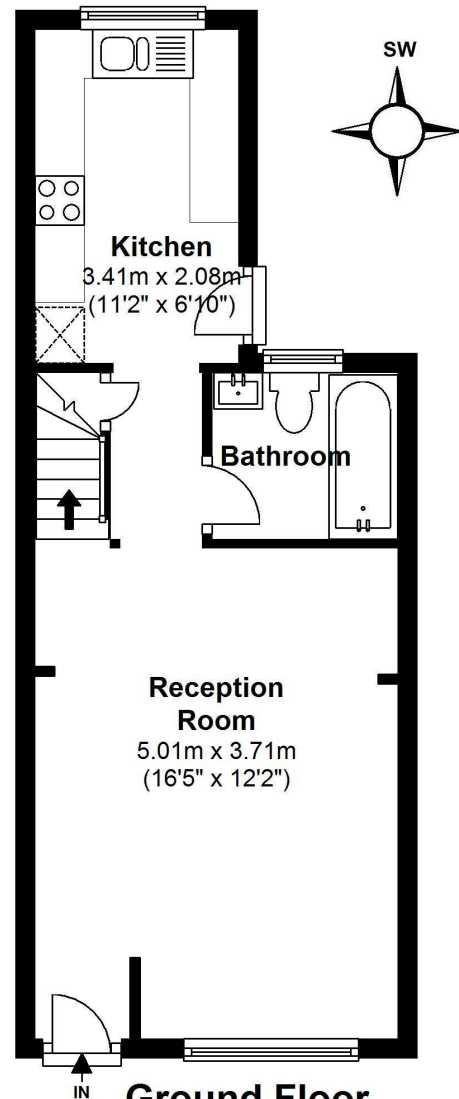

Floor area approx. = 347 Sq. Feet ( 32.27 sq.metres)

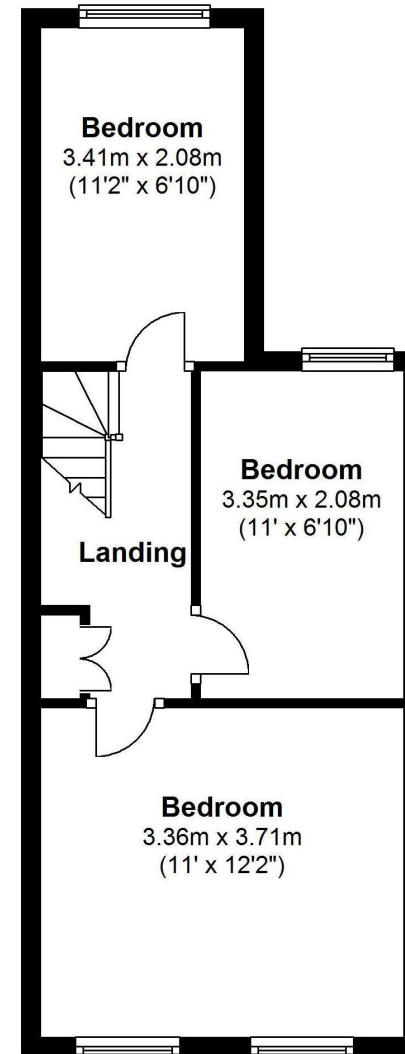

Floor area approx. = 347 Sq. Feet (32.27sq.metres)

Gross Floor area approx. = 695 Sq. Feet(64.54sq.metres)

**a** Websters Estate Agents 36 Broad Street, Teddington, Middlesex TW11 8QY

**t** 020 8614 6000

**e** sales@mywebsters.co.uk **w** mywebsters.co.uk

**Disclaimer**

These particulars, whilst believed to be accurate are set out as a general outline only for guidance and do not constitute any part of an offer or contract. Intending purchasers should not rely on them as statements of representation of fact, but must satisfy themselves by inspection or otherwise as to their accuracy. We have not carried out a detailed survey nor tested the services, appliances and specific fittings. Room sizes should not be relied upon for carpets and furnishings. The measurements given are approximate. No person in this firm's employment has the authority to make or give any representation or warranty in respect of the property.

