



Websters
estate agents
0203 8802 3343
mywebsters.co.uk For Sale

Websters
estate agents

Roxborough Avenue, Isleworth, TW7 5HH

Attractive and well styled 5 bedroom semi detached house in a lovely residential area of Isleworth.

Well presented home with pleasing décor throughout, offering 1692 sq ft of versatile well planned and spacious family living over 3 floors.

Entrance hallway leads to the study, 2 reception rooms and a bathroom. The fabulous kitchen/breakfast room is accessed from the rear reception room with both rooms having doors directly onto the mature beautifully kept garden. With patio and a lawn area, the garden also benefits from a brick built summer house/office.

On the first floor are 4 bedrooms one with ensuite shower room, the family bathroom and plenty of built in storage. The second floor houses the 5th bedroom and an ensuite shower room.

The driveway provides off street parking for 2 cars and the property is within 1 mile of Osterley tube station and Isleworth train station.

EPC Rating C.

- 5 Bedroom Semi Detached House
- 1692 Sq Ft Accommodation
- 3 Reception Rooms
- Luxury Kitchen/Breakfast Room
- 2 Modern Bathrooms
- Off Street Parking for 2 Cars
- Brick Built Summer House/Home Office



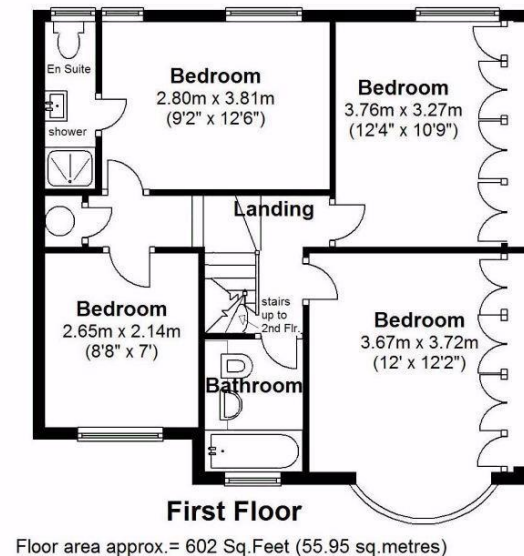
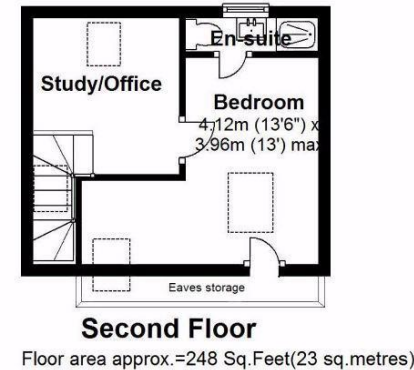
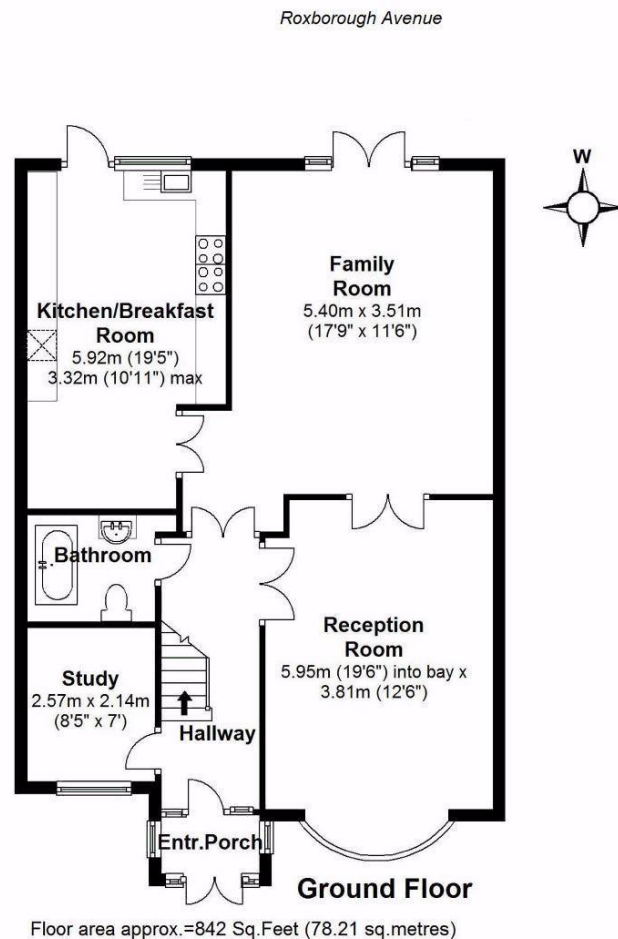

Gross Floor Area approx.=1,692 Sq.Feet (157sq.metres)

a Websters Estate Agents 36 Broad Street, Teddington, Middlesex TW11 8QY **t** 020 8614 6000 **e** sales@mywebsters.co.uk **w** mywebsters.co.uk

Disclaimer

These particulars, whilst believed to be accurate are set out as a general outline only for guidance and do not constitute any part of an offer or contract. Intending purchasers should not rely on them as statements of representation of fact, but must satisfy themselves by inspection or otherwise as to their accuracy. We have not carried out a detailed survey nor tested the services, appliances and specific fittings. Room sizes should not be relied upon for carpets and furnishings. The measurements given are approximate. No person in this firm's employment has the authority to make or give any representation or warranty in respect of the property.

