



NORCUTT RD

Websters
estate agents

Norcutt Road, Twickenham, TW2 6SR

End of terrace Victorian cottage in a residential road 300 metres from Twickenham Green, local shops, bars and restaurants.

Superbly presented throughout with light neutral decor in a dual aspect corner location offering open plan living space.

Front door opens into the open plan downstairs living/dining/kitchen, a separate utility area and w.c/shower room. Door opens onto the patio garden at the rear. With double gate access, this area offers potential to become off street parking (subject to Council agreement). Upstairs are 2 double bedrooms and an ensuite bathroom.

To the front/side is unrestricted road parking, just 700 metres from Twickenham Mainline and Strawberry Hill Stations.

EPC Rating E

- End of Terrace Victorian Cottage
- Superbly Presented Throughout
- Open Plan Living Space
- Utility Room and Shower Room
- 2 Double Bedrooms
- Upstairs Bathroom
- Courtyard Patio Garden
- 0.7 Miles from Twickenham Mainline Station



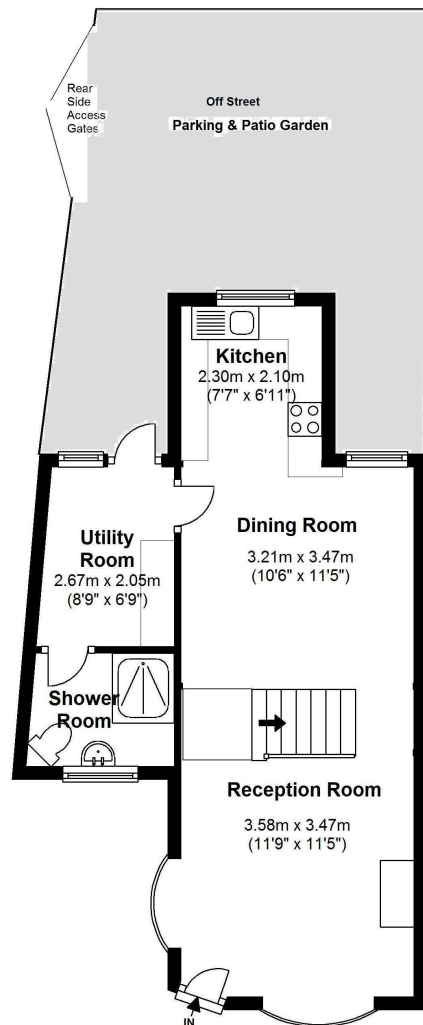

Ground Floor

Floor area approx. = 433 Sq.Feet (40.27 sq.metres)

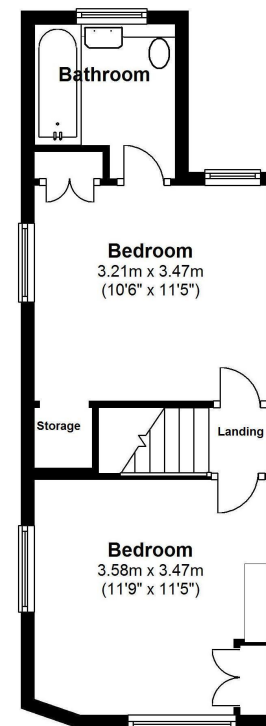

First Floor

Floor area approx. = 342 Sq.Feet (31.80 sq.metres)

Gross Floor area approx. = 776 Sq.Feet (72.07 sq.metres)

a Websters Estate Agents 36 Broad Street, Teddington, Middlesex TW11 8QY

t 020 8614 6000

e sales@mywebsters.co.uk **w** mywebsters.co.uk

Disclaimer

These particulars, whilst believed to be accurate are set out as a general outline only for guidance and do not constitute any part of an offer or contract. Intending purchasers should not rely on them as statements of representation of fact, but must satisfy themselves by inspection or otherwise as to their accuracy. We have not carried out a detailed survey nor tested the services, appliances and specific fittings. Room sizes should not be relied upon for carpets and furnishings. The measurements given are approximate. No person in this firm's employment has the authority to make or give any representation or warranty in respect of the property.

